



CHUNG CHUAN PUMP

CHUNG CHUAN PUMP

ISO 9001:2000 certificate

DS Vertical Sewage Centrifugal Pump

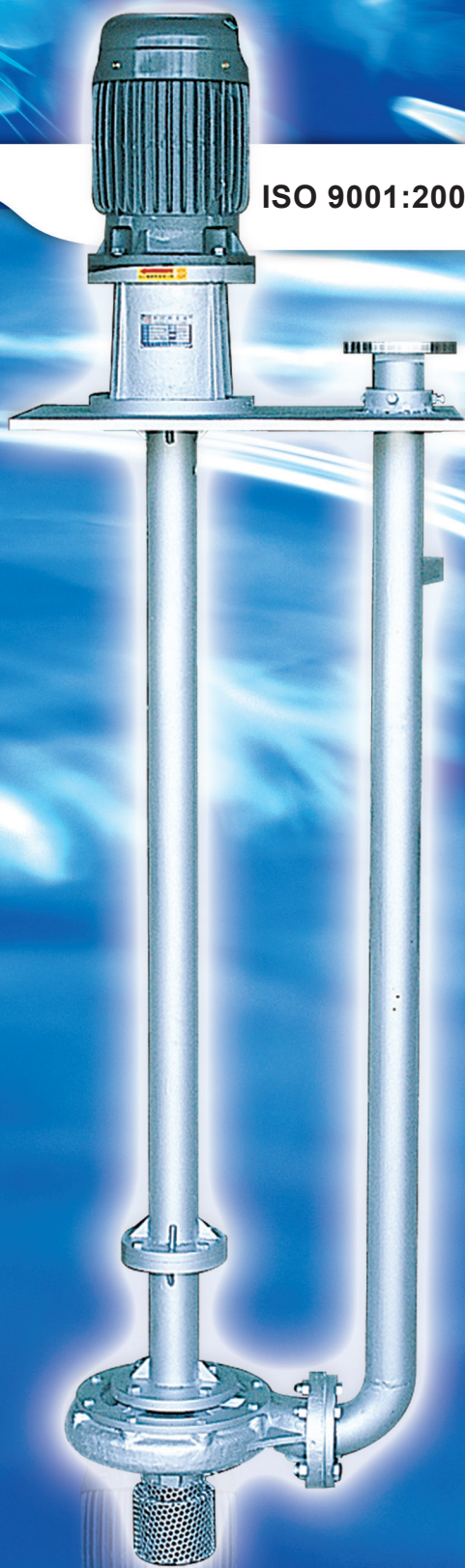

Trustworthy • Professional • Creative



DS Vertical Sewage Centrifugal Pump

Model: DS Max. Head: 50M Max. Capacity: 10 m³/min Discharge: 1"-10" Motor Power: 1 -100 HP

Features

1. There is no need for water filling during operation, and it is based on semi-open impeller.
2. Since the impeller is immersed in water, the suction head is not limited.
3. The base plate can be installed on the sewage sump via the form of standard flange.
4. Simple structure with easy maintenance.

Structure Description

1. Filter screen: it is the inlet protective net which can prevent incoming foreign objects from blocking the impeller, thus reducing the malfunction.
2. Impeller: it is the precisely machined semi-open impeller to be tightly matched with the pump case to reduce the leakage loss. All impellers have gone through dynamic and static balance calibration such that the operation is smooth without any vibration. It can work with the liquid with high viscosity and numerous suspended solids. The impeller can also be made of wear resistant steel.
3. Pump shaft: it is made of SUS 410/304/316 stainless steel with precise machining and grinding. The shaft is isolated from the water outlet pipelines to prolong the service life.
4. Central bearing frame: bearing frames are installed between column tubes to avoid excessive pump shaft span and to keep the operation smooth and stable.
5. Lubrication: the bearing is lubricated directly by the liquid delivered by the pump. However, this liquid should be the wastewater containing fewer impurities (or oil containing wastewater).
6. Rotational direction: clockwise rotation from top view.
7. Transmission direction: it is transmitted towards the motor via coupler.

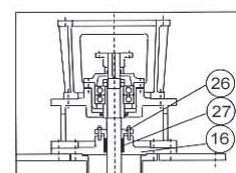
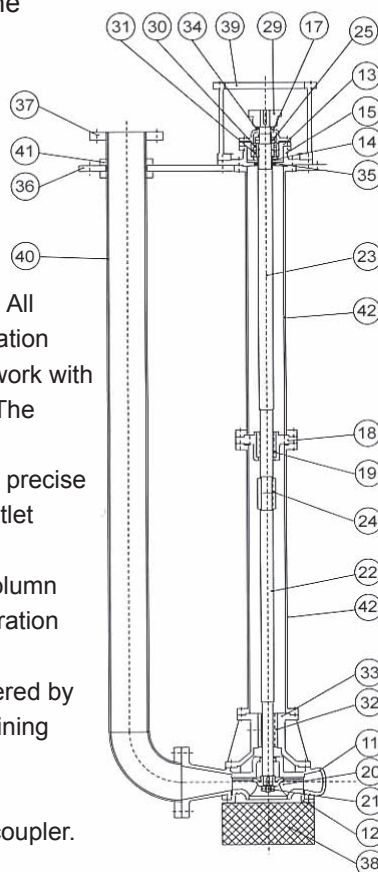

Soft Parking

Note: Pump shaft lubrication approach – lubricated by internal liquid or external clear water.

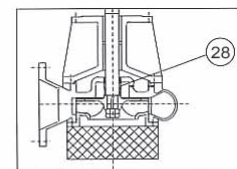

Mechanical seal

Note: Pump shaft lubrication approach- lubricated by machine oil or external clear water.

Application

Petrochemical industry, pumping and drainage of wastewater and waste oil, and building and factory sewage treatment.

Construction

Number	Part Name	Materials			Number	Part Name	Materials		
11	Pump casing	FC 20	SCS 13	SCS 14	27	Gland packing	V#133	V#7133	V#7133
12	Suction cover	FC 20	SCS 13	SCS 14	28	Mechanical seal			
13	Bearing houseing	FC 20	FC 20	FC 20	29	Coupling	FC 20		
14	Bearing lining		SS 41		30	Bearing	F.A.G./N.S.K.		
15	Bearing cover		FC 20		31	Bearing	F.A.G./N.S.K.		
16	Stuffing box	FC 20	SCS 13	SCS 14	32	Bearing	BC 6		
17	Bearing cover	FC 20	FC 20	FC 20	33	Adapter	FC 20	SCS 13	SCS 14
18	Bearing bracket	FC 20	SCS 13	SCS 14	34	Flinger	BC 6		
19	Bearing		BC 6		35	Oil seal	RUBBER		
20	Impeller	FC 20	SCS 13	SCS 14	36	Support plate	SS 41		
21	Impeller lock nut	SUS 304	SUS 304	SUS 316	37	Flange	SS 41	SUS 304	SUS 316
22	Pump shaft	SUS 410	SUS 304	SUS 316	38	Strainer	SUS 304	SUS 304	SUS 316
23	Head shaft	SUS 410	SUS 304	SUS 316	39	Motor pedestal	FC 20		
24	Shaft joint		SS 41		40	Discharge pipe	S.G.P	SUS 304	SUS 316
25	Screw nut		SS 41		41	Impeller lock nut	SS 41		
26	Gland	FC 20	SCS 13	SCS 14	42	Column pipe	S.G.P	SUS 304	SUS 316



DS Dimension Diagram

Model Code	25 S 160	25 S 210	40 S 130	40 S 160	40 S 210	40 S 250	50 S 160	50 S 210	50 S 250	50 S 320	65 S 210	65 S 250	80 S 210	80 S 250	80 S 290
A	400	535	350	535	570	625	570	600	650	698	650	670	670	730	740
B	350	415	290	475	510	565	510	540	590	638	590	610	610	670	670
C	220	215	165	228	235	265	260	270	290	338	310	330	320	335	360
D	65	100	50	100	110	110	100	110	110	110	120	120	130	135	130
E	115	220	135	220	225	250	210	220	250	250	220	220	220	240	250
F	350	460	300	460	460	540	460	460	540	540	450	470	470	560	560
G	300	400	240	400	400	480	400	400	480	480	390	410	410	530	500
H(I)	25	30	30	30	30	30	30	30	30	30	30	30	30	30	30
J	120	120	120	120	120	150	150	150	150	150	150	150	150	150	150
K ϕ	25	25	40	40	40	40	50	50	50	50	65	65	75	75	75
n-d ϕ	415	415	415	415	415	415	415	415	415	415	415	415	415	415	415
L	305	355	280	370	385	490	410	470	460	608	516	550	545	577	640

Model Code	80 S 320	100 S 210	100 S 250	100 S 290	100 S 320	125 S 290	125 S 360	150 S 210	150 S 290	150 S 320	150 S 400	200 S 250	200 S 290	200 S 320	200 S 360	250 S 290
A	880	790	855	855	930	950	1030	1030	1050	1230	1320	1000	1055	1140	1500	1560
B	820	730	795	795	850	870	950	950	970	1150	1270	920	975	1060	1400	1400
C	420	390	430	439	450	515	500	455	575	605	680	450	485	490	772	772
D	130	150	150	150	150	160	140	260	170	240	150	250	250	250	205	265
E	330	250	275	275	330	275	390	315	305	385	490	300	320	400	523	523
F	730	560	600	600	750	700	870	680	920	850	1050	850	900	1000	1020	1020
G	670	500	540	540	670	620	790	600	840	870	970	770	820	920	920	920
H(I)	30	30	30	30	40	40	40	40	40	40	40	40	40	40	50	50
J	150	150	150	150	150	150	150	150	150	150	150	150	150	150	150	150
K ϕ	75	100	100	100	100	125	125	150	150	150	150	200	200	200	200	250
n-d ϕ	415	415	415	415	415	419	419	419	423	423	423	423	423	423	423	423
L	720	600	700	710	717	770	920	730	875	880	1030	790	850	900	1140	1190

*Our company retains the right of data variation, so please make necessary confirmation before purchase.

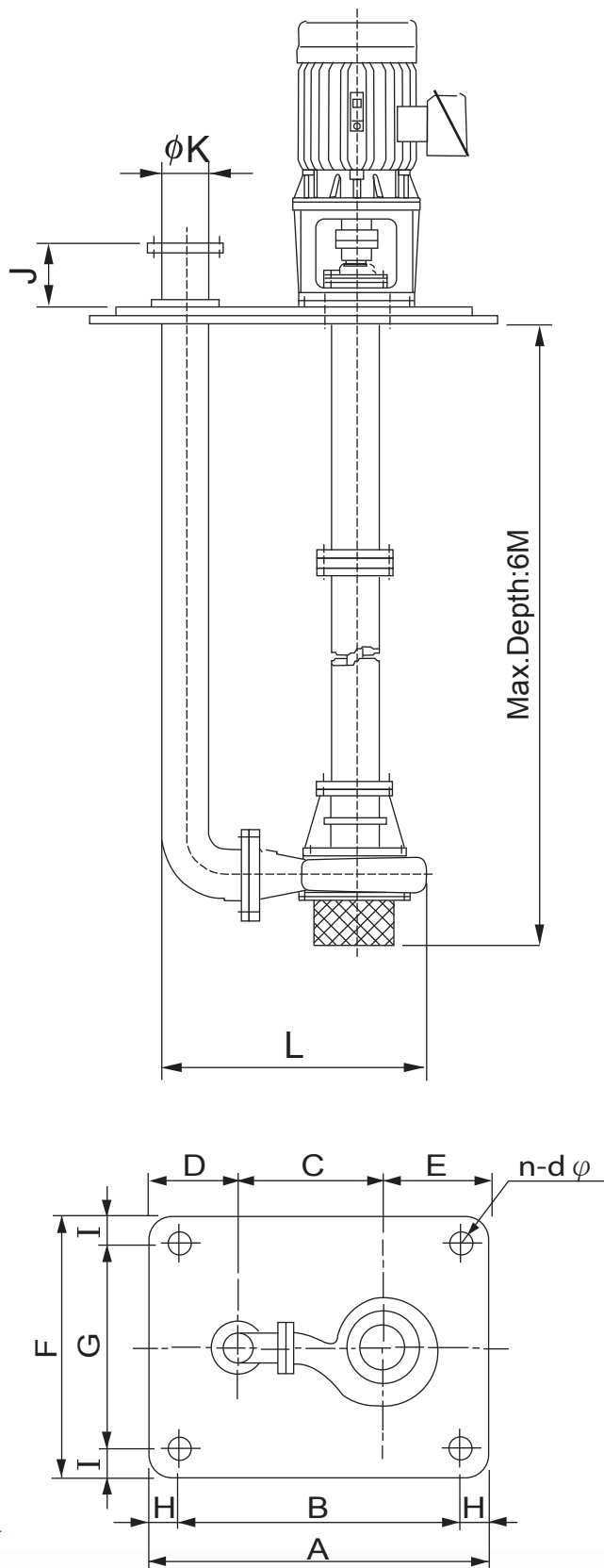



CHUNG CHUAN PUMP

CHUNG CHUAN PUMP

DS Performance Curve Diagram

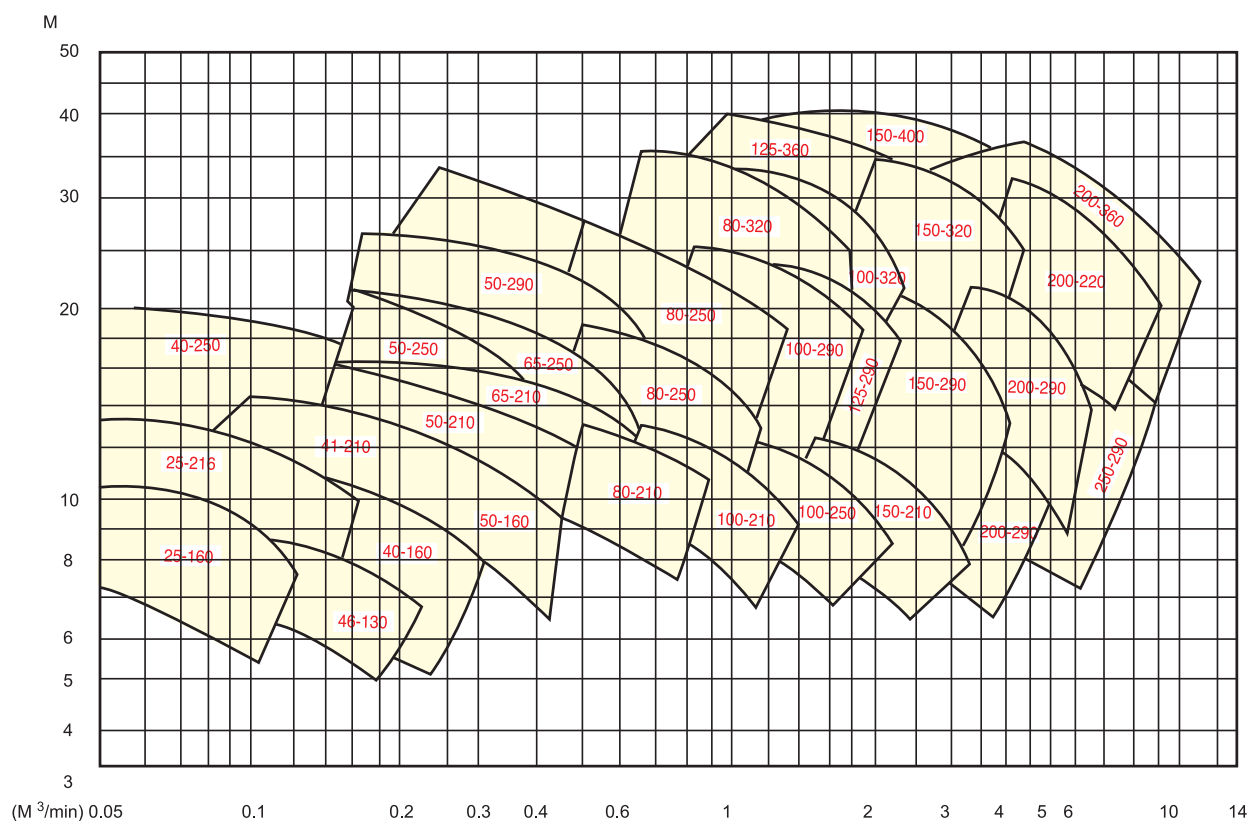
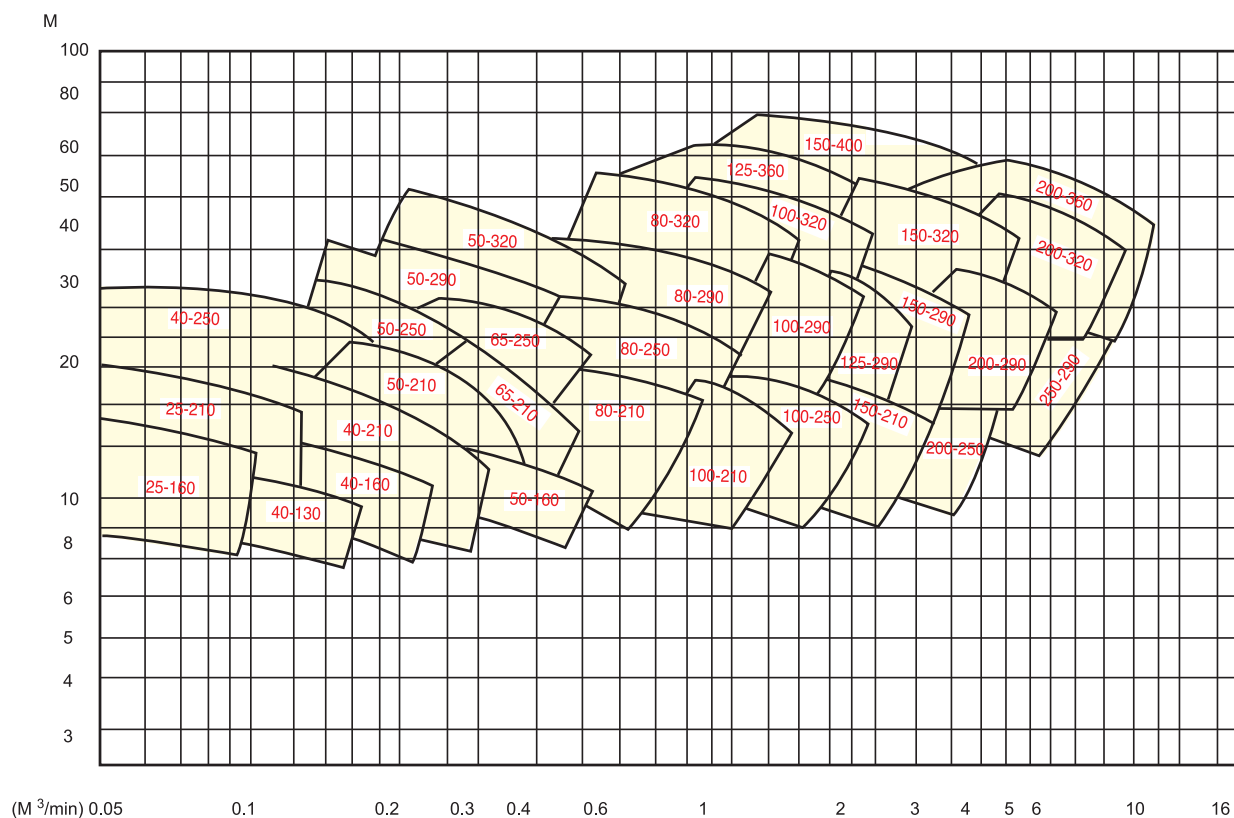

*Our company retains the right of data variation, so please make necessary confirmation before purchase.

DA CHUAN PUMP INDUSTRIAL CO., LTD.

<http://www.cnc-pump.com.tw>

TEL: (02) 2847-6261 FAX: (02) 2289-1677

E-mail: cncpump@yahoo.com.tw