



CNC PUMP

CHS型

Stainless Horizontal Multi-Stage Centrifugal Pumps

不銹鋼臥式多段離心泵浦

50/60 Hz



● Application

CHS,CHSK type pump are mainly used in industrial field:

- Air-conditioning system
- Cooling system
- Industrial cleaning
- Water treatment (Water purification)
- Aquiculture
- Fertilizing / metering system
- Environmental application
- Other special applications

● Applicable medium

- Thin and clean non-flammable and non-explosive liquid without solid granules and fibers.
- Mineral water, soft water, pure water, edible vegetable oil and other light chemical mediums.
- When the density or viscosity of to-be-conveyed liquid is larger than that of water, it is necessary to select a driving motor of high-power.
- Whether a specific liquid is suitable for the pump depends on many factors, among which the most important ones are chlorine content, PII value, temperature, solvent and oil content.

● Pump

- Horizontal multistage non-self-priming centrifugal pump, attached with long shaft electric motor.
- Compact structure renders small size of pump; axial inlet and radial outlet.

● Definition of Model

CHS Example

CHS 4 - 30
 Stage × 10
 Rated flow m³/h

Light horizontal multistage centrifugal pump
 (Flow passage components stainless steel 304 or 316)

CHSK Example

CHSK K 4 - 30
 Stage × 10
 Rated flow m³/h

Stainless steel air-conditioning pump
 Light horizontal multistage centrifugal pump
 (Flow passage components stainless steel 304 or 316)

● Material CHS/CHSK

No.	Name	Material	AISI / ASTM
1	Inlet and outlet chamber	Stainless steel	AISI304(SUS316)
2	Connection pipe	Stainless steel	AISI304(SUS316)
3	Clamp plate	Stainless steel	AISI304(SUS316)
4	Impeller	Stainless steel	AISI304(SUS316)
5	Shaft	Stainless steel	AISI304(SUS316)
6	Gag	Stainless steel	AISI304(SUS316)
7	Discharge diffuser	Stainless steel	AISI304(SUS316)
8	Mechanical seal		
9	Motor end cover	Aluminum alloy	
10	Base plate	Cast iron	ASTM25B
11	Quick joint	Stainless steel	AISI304(SUS316)
12	Diffuser	Stainless steel	AISI304(SUS316)
13	Support diffuser	Stainless steel	AISI304(SUS316)
14	Inducer	Stainless steel	AISI304(SUS316)

● Curve conditions

Following conditions are suitable for the performance curves shown above.

- All curves are based on the measured values of 50Hz: constant motor speed 2900r/min, 60 Hz: constant motor speed 3500 r/min;
- Curve tolerance in conformity with ISO9906 Annex A.
- Measurement is done with 20°C air-free water, kinematic viscosity of 1mm²/sec.
- The operation of pump shall refer to the performance region described by the thickened curve to prevent overheating due to too small flow rate or overload of motor due to too large flow rate.

● Motor

- TEFC motor 2-pole
- Protection class:IP55
- Insulation class:F
- Standard voltage, 50Hz: 1 × 220-240V
3 × 220-240V/380-415V
- Standard voltage, 60Hz: 1 × 220-240V
3 × 220-240V/380-415V
- Single phase motor(max):2.4KW

● Operation condition

- Liquid temperature:
Normal temperature type:-15°C~+70°C
Hot water type: +70°C~+110°C
- Ambient temperature: up to +40°C
- Max.operation pressure:10 bar
- Max.inlet pressure is limited by max. Operation pressure

● Section drawing CHS/CHSK 2,4

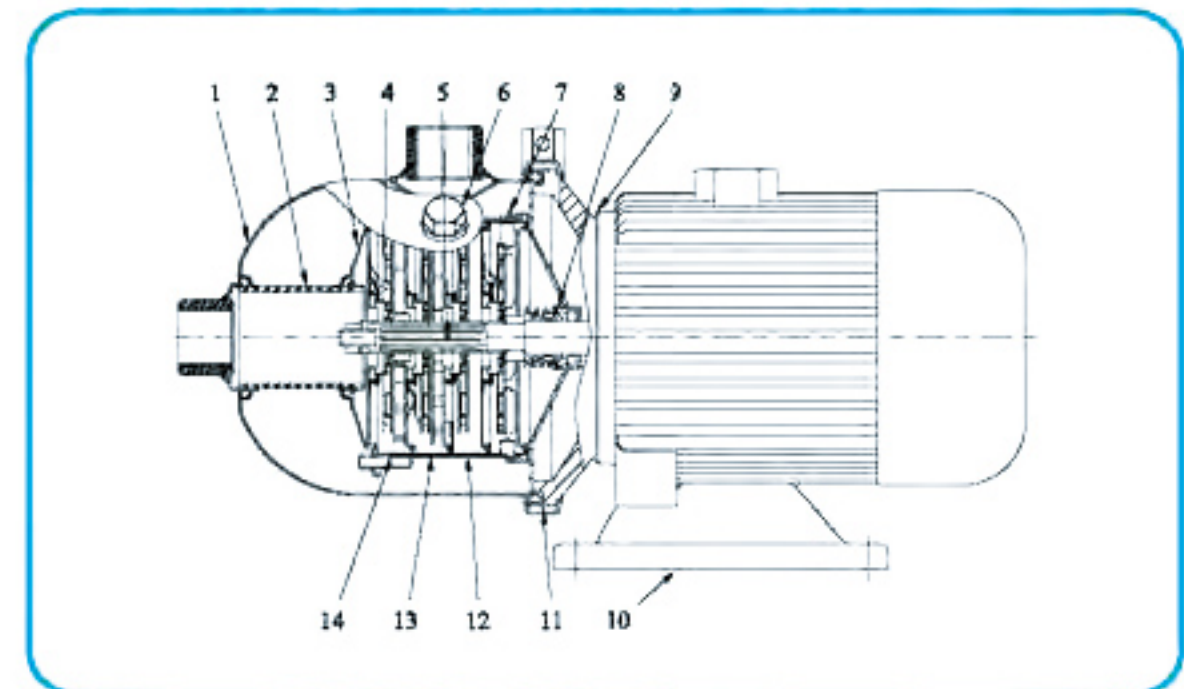

● Section drawing CHS/CHSK 8,12,15,16,20

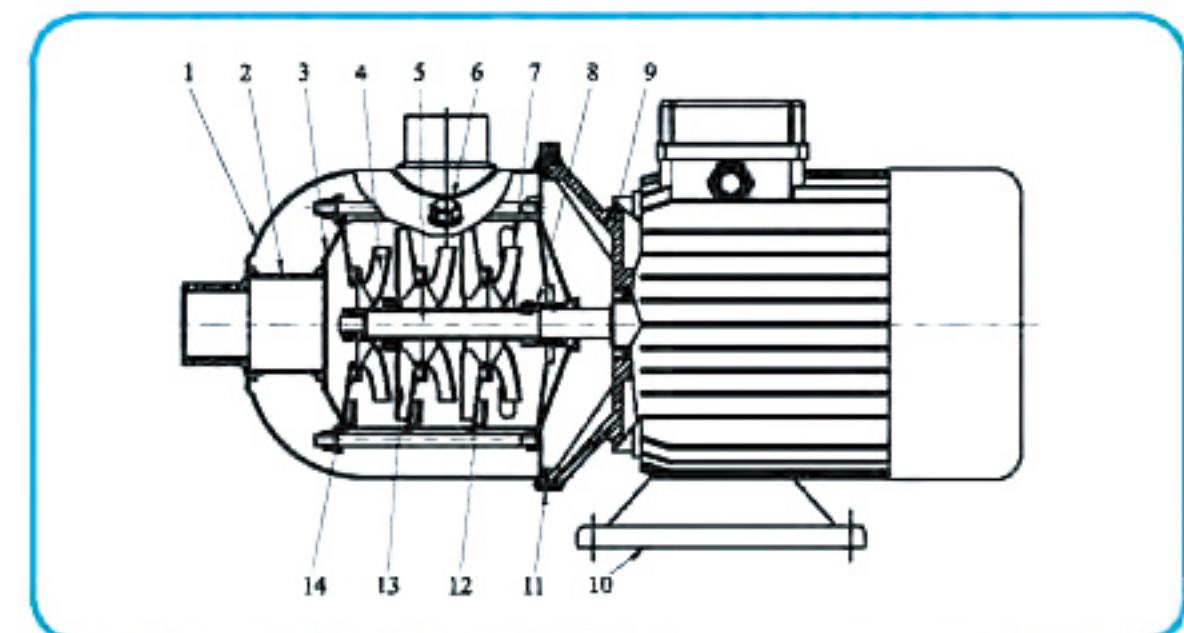

CHS 2 50HZ

● Performance table

Model	Driving motor		Q (m ³ /h)	0.5	1	1.5	2	2.5	3	3.5
	(kW)	(hp)								
CHS2-20	0.37	0.5	H (m)	19	18	16.5	15	13	10	7.5
CHS2-30	0.37	0.5		28	26.5	24.5	22	19	15.5	12
CHS2-40	0.55	0.75		36	34.5	33	29	25	20.5	16
CHS2-50	0.55	0.75		45.5	43	40	36	31.5	26.5	20.5
CHS2-60	0.75	1		53.5	51	48	44	39	32	24

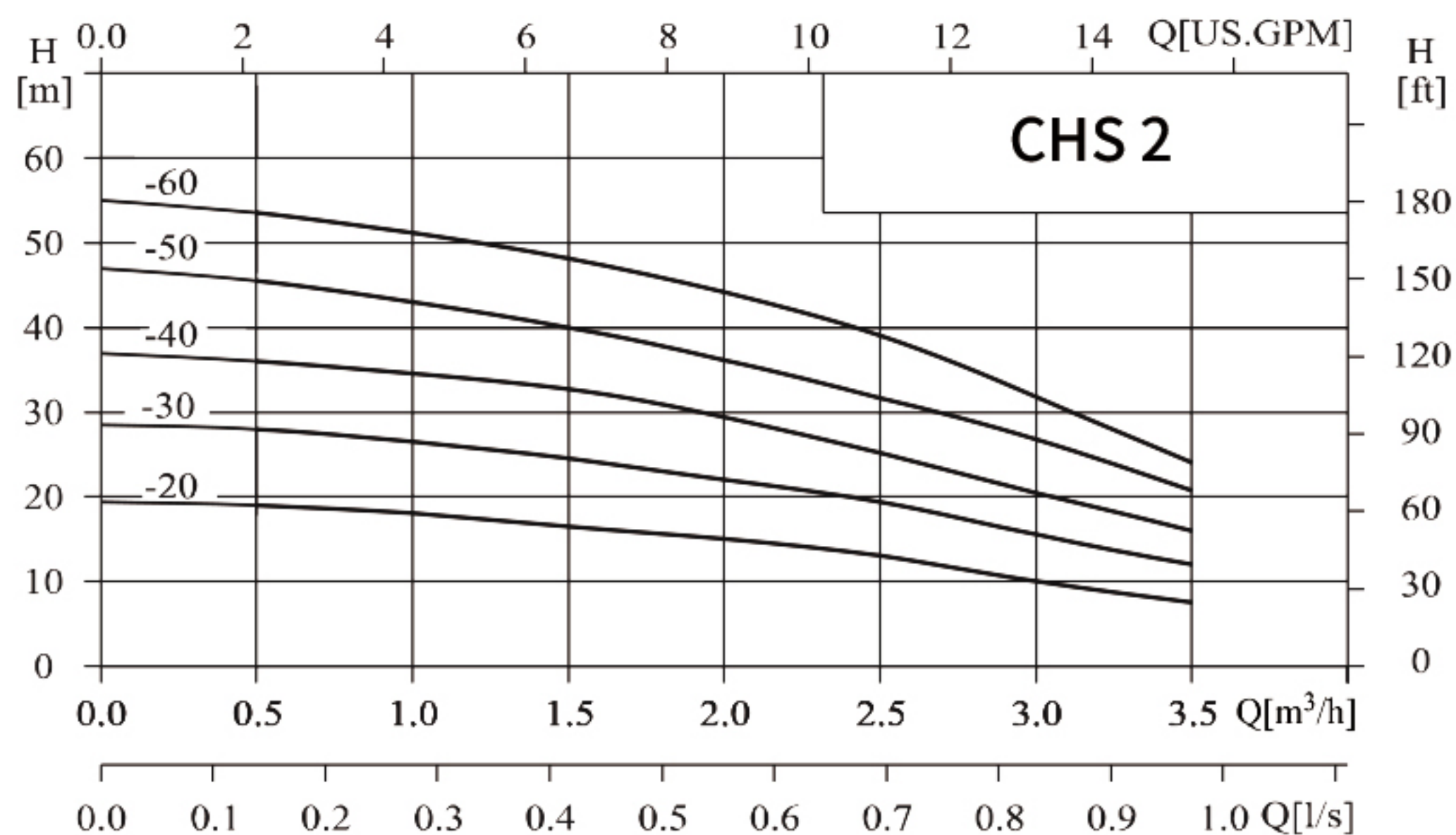

● Installation sketch

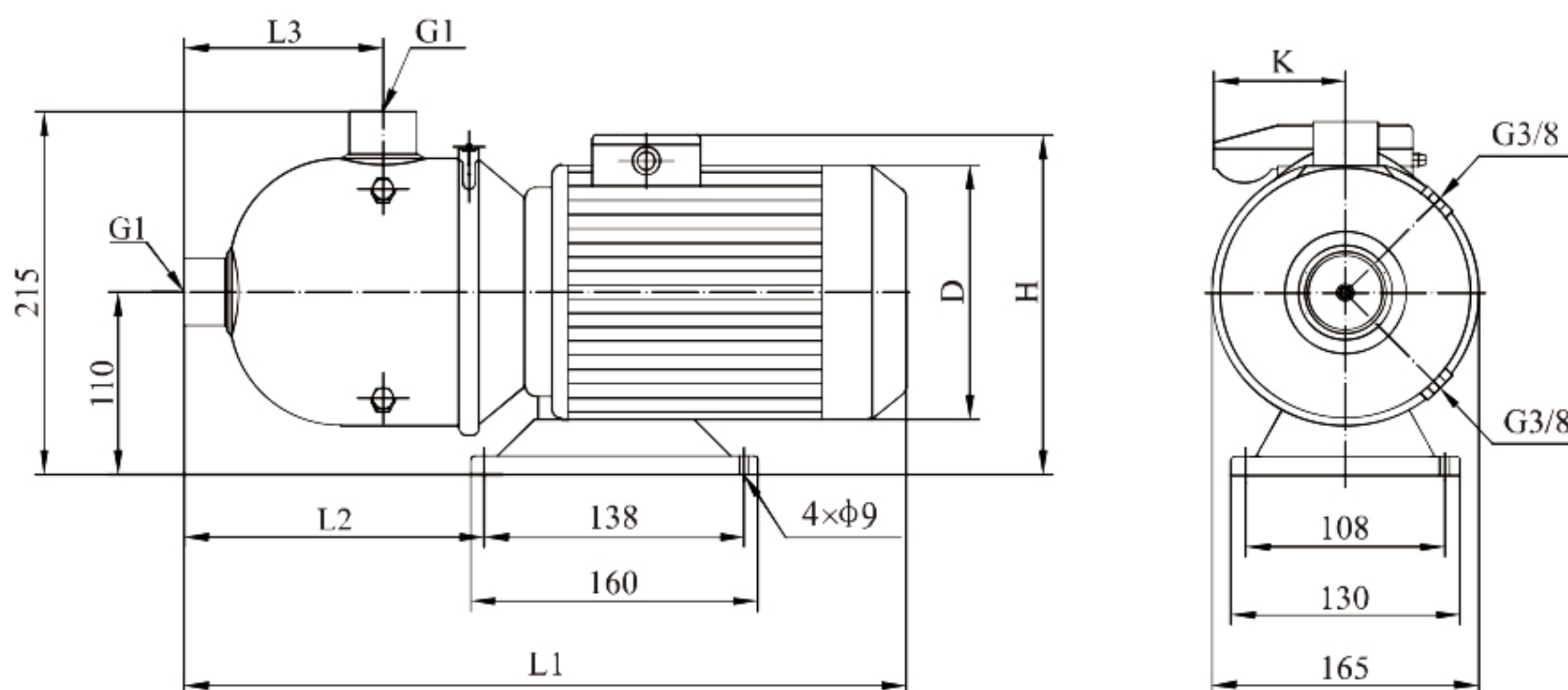

● Size and weight

Motor	Model	Size (mm)						Weight (kg)
		L1	L2	L3	D	H	K	
Three-phase/ single-phase	CHS2-20	400	165	125	141	215/249	/62	10
	CHS2-30	400	165	125	141	215/249	/62	10
	CHS2-40	400	165	125	141	215/249	/62	11
	CHS2-50	400	165	125	141	215/249	/62	12
	CHS2-60	420	165	125	151/161	225/265	/91	14

CHS 4 50HZ

● Performance table

Model	Driving motor		Q (m ³ /h)	1	2	3	4	5	6	7
	(kW)	(hp)								
CHS4-20	0.37	0.5	H (m)	19	18	17	15	12.5	10	8
CHS4-30	0.55	0.75		28	27	26	23.5	20.5	17	13
CHS4-40	0.75	1		37.5	36	34	31	27	23	19

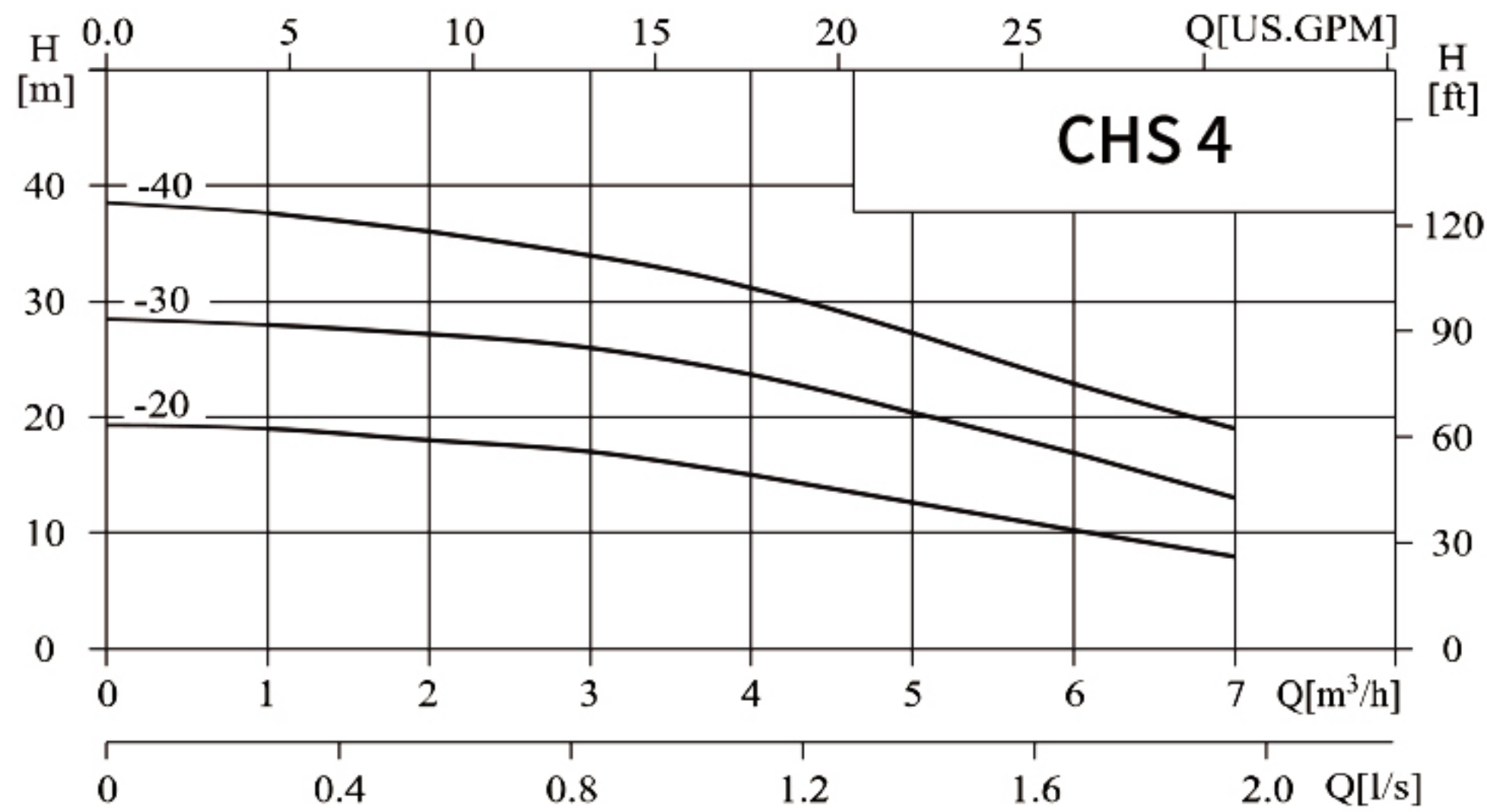

● Installation sketch

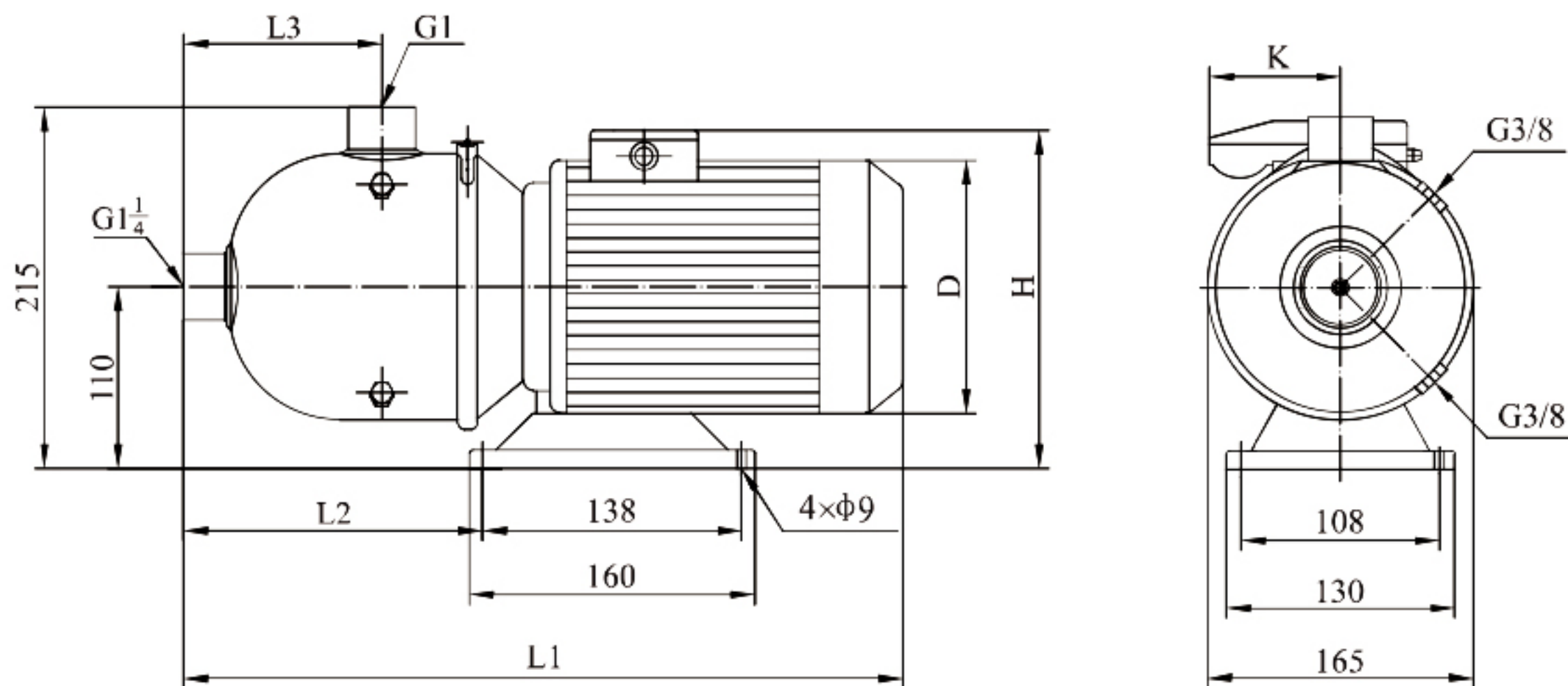

● Size and weight

Motor	Model	Size (mm)						Weight (kg)
		L1	L2	L3	D	H	K	
Three-phase/ single-phase	CHS4-20	400	172	132	141	215/249	/62	10
	CHS4-30	400	172	132	141	215/249	/62	11
	CHS4-40	420	172	132	151/161	225/265	/91	14

CHS 8 50HZ

● Performance table

Model	Driving motor		Q (m ³ /h)	5	6	7	8	9	10	11
	(kW)	(hp)								
CHS8-10	0.75	1	H (m)	10	9.5	9.3	9	8	7.5	7
CHS8-20	0.75	1		20	19.5	19	18	17	15.5	14
CHS8-30	1.1	1.5		29.5	29	28	27	25	23	21
CHS8-40	1.5	2		39	38	37	35	33	30.5	27.5
CHS8-50	2.2	3		51	49.5	47.5	45	42.5	39.5	36

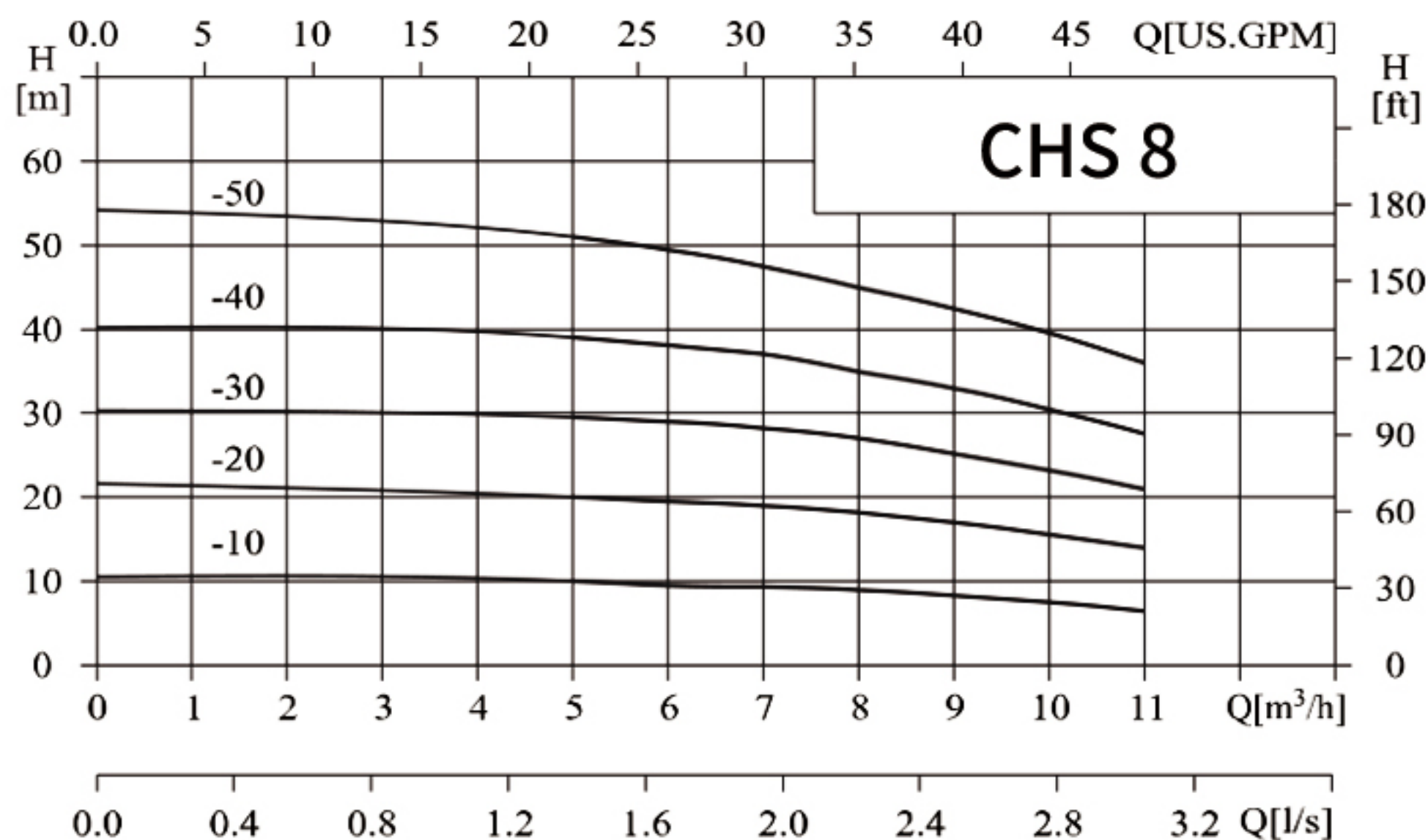

● Installation sketch

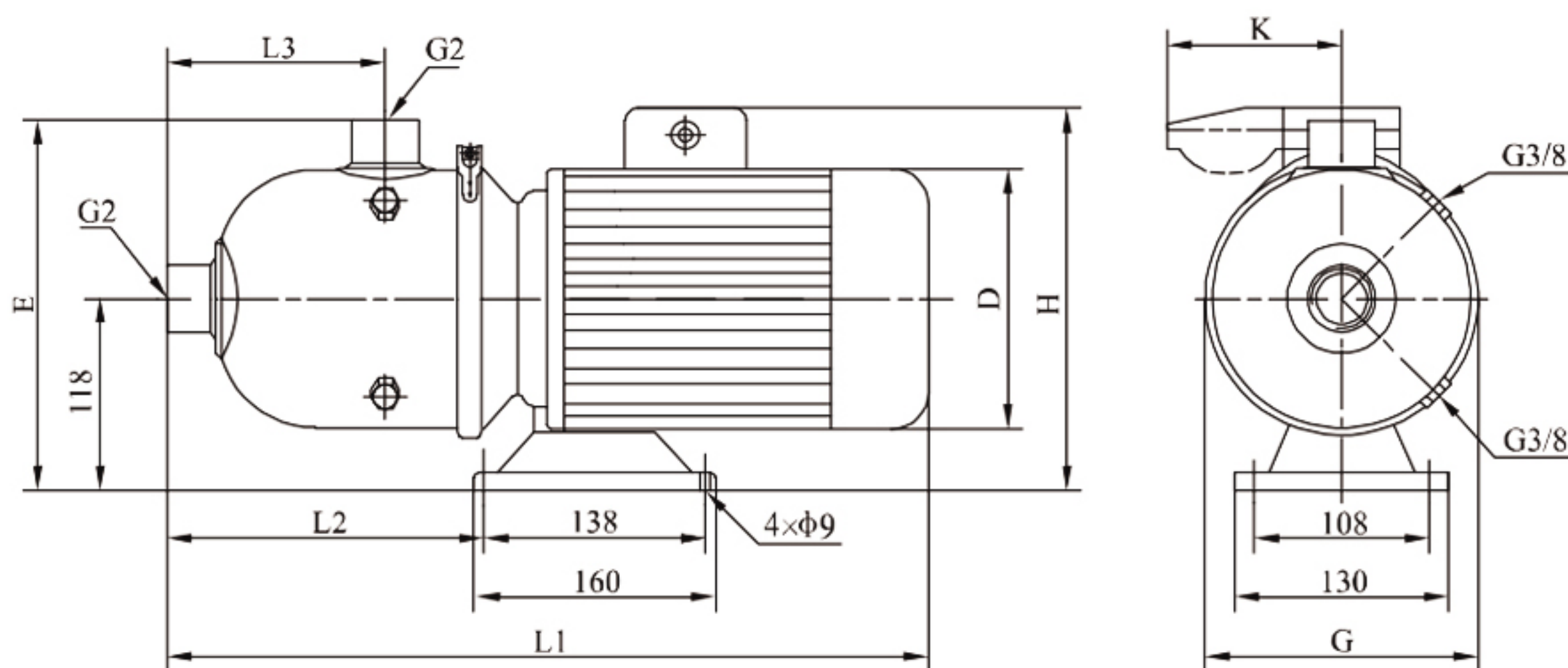

● Size and weight

Motor	Model	Size (mm)								Weight (kg)
		L1	L2	L3	E	G	D	H	K	
Three-phase/ single-phase	CHS8-10	530	279	176	264	223	151/161	225/265	/91	18
	CHS8-20	530	279	176	264	223	151/161	225/265	/91	19
	CHS8-30	530	279	176	264	223	151/161	230/265	/91	22
	CHS8-40	563	279	176	265	223	171/176	235/270	/91	27
	CHS8-50	563	279	176	265	223	171/176	235/270	/91	32

CHS 12 50HZ

● Performance table

Model	Driving motor		Q (m ³ /h)	7	8	9	10	11	12	13	14	15	16
	(kW)	(hp)		H (m)									
CHS12-10	0.75	1		11.5	11.2	11	10.5	10	9.5	9	8	7	6
CHS12-20	1.2	1.6		23	22.5	22	21.5	20.5	19.5	18.5	17	15.5	13
CHS12-30	1.8	2.4		35	34.5	33.5	32.5	31	29.5	28	26	23.5	20
CHS12-40	2.4	3.3		47	46	45	43.5	41.5	39.5	37.5	35	31.5	27.5
CHS12-50	3	4		60	58	56.5	55	52.5	50	47	44	40	35

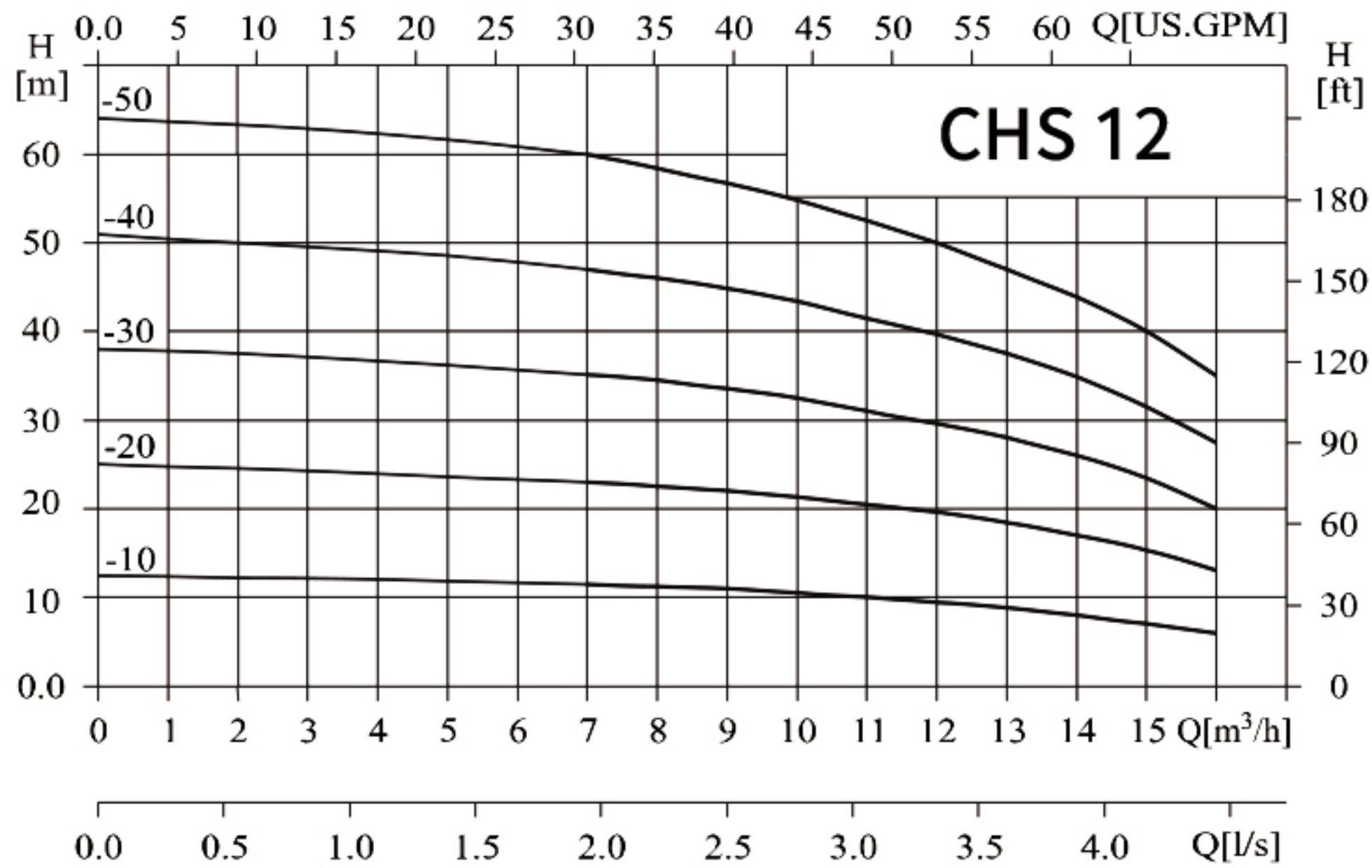

● Installation sketch

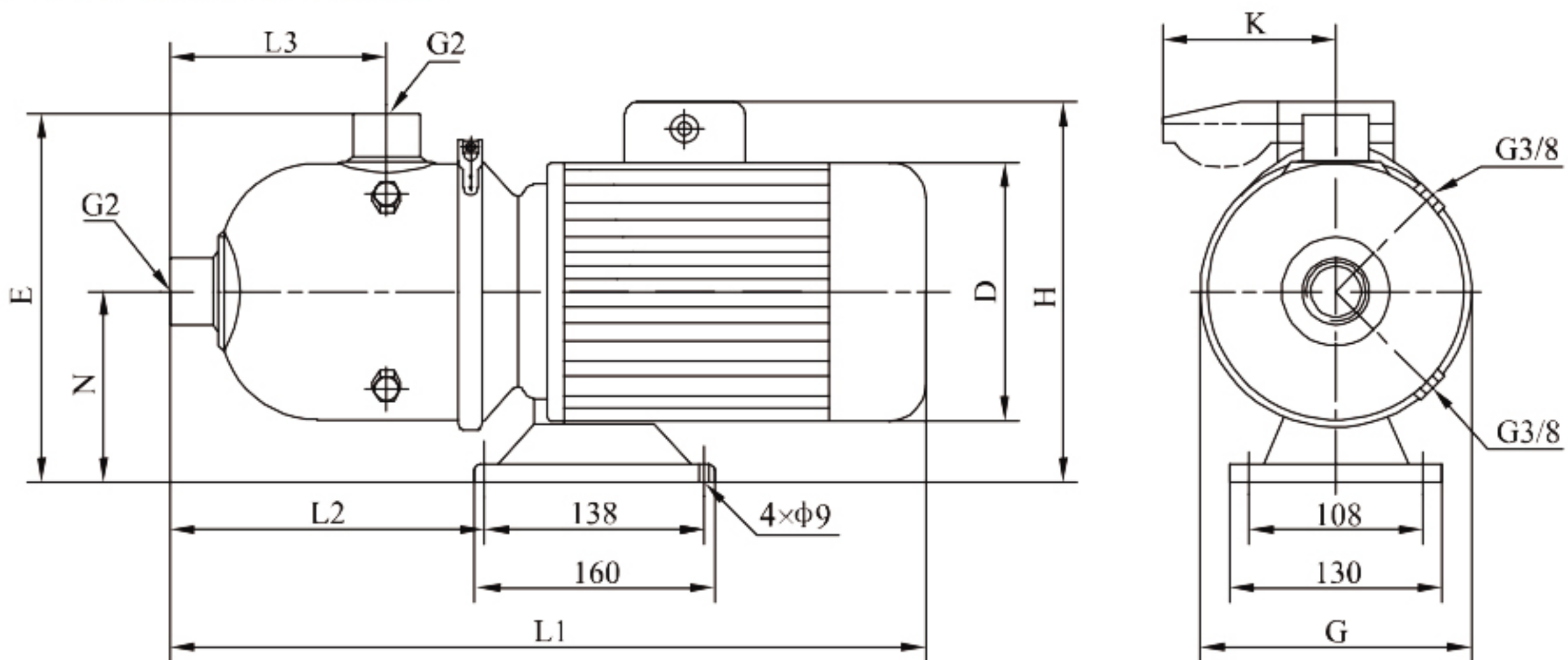

● Size and weight

Motor	Model	Size (mm)									Weight (kg)
		L1	L2	L3	N	E	G	D	H	K	
Three-phase/ single-phase	CHS12-10	530	279	176	117	264	223	151/161	225/265	/91	18
	CHS12-20	530	279	176	117	264	223	151/161	225/265	/91	22
	CHS12-30	563	279	176	118	265	223	171/176	235/270	/91	28
	CHS12-40	563	279	176	118	265	223	171/176	235/270	/91	33
	CHS12-50	610	279	176	128	275	223	196/	259/		37

CHS 15 50HZ

● Performance table

Model	Driving motor		Q (m ³ /h)	8	10	12	14	15	16	18	20	22
	(kW)	(hp)										
CHS15-10	1.1	1.5	H (m)	12	11	10.5	9.5	9	8.5	7.5	6.5	6
CHS15-20	2.2	3		24.5	24	23	22	21	20.5	19	18	16
CHS15-30	3	4		38	37	35.5	34	33	32	30	28	25

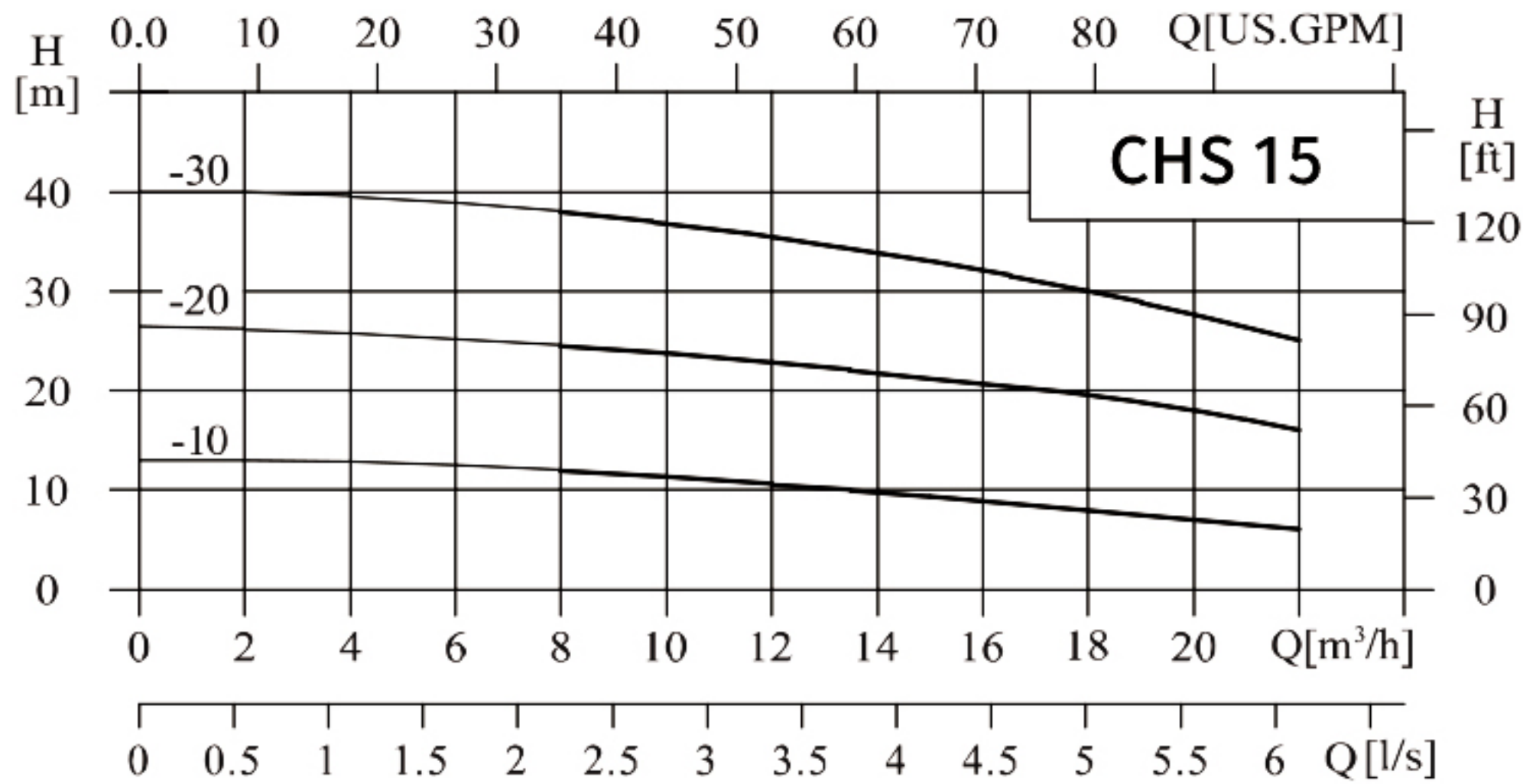

● Installation sketch

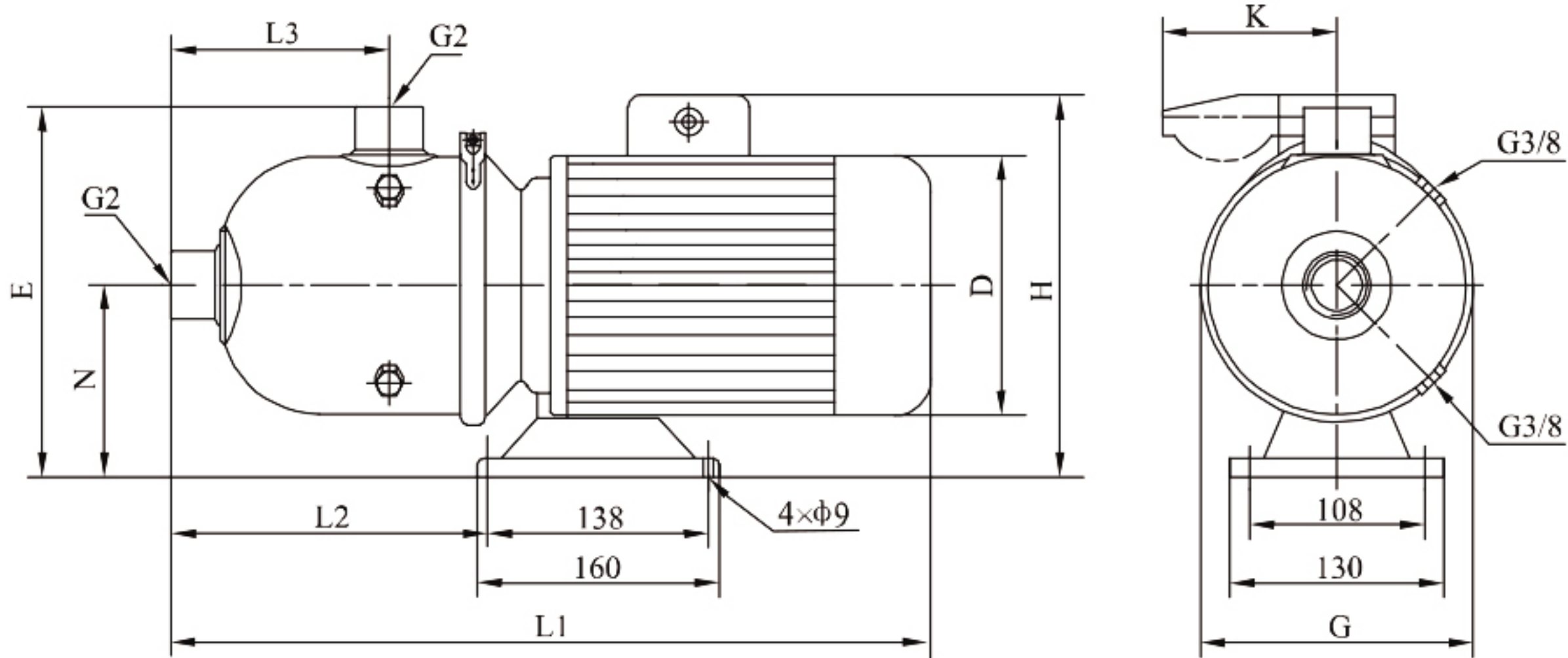

● Size and weight

Motor	Model	Size (mm)									Weight (kg)
		L1	L2	L3	N	E	G	D	H	K	
Three-phase/ single-phase	CHS15-10	530	279	176	117	264	223	151/161	225/265	/91	20
	CHS15-20	563	279	176	118	265	223	171/176	235/270	/91	26
	CHS15-30	605	279	176	128	275	223	196/	259/		34

CHS 20 50HZ

● Performance table

Model	Driving motor		Q (m ³ /h)	10	12	14	16	18	20	22	24	26	28
	(kW)	(hp)		H (m)									
CHS20-10	1.1	1.5	H (m)	13.5	13	12.5	12	11	10	9	8	7	6
CHS20-20	2.2	3		27	26.5	25.5	25	23.5	22	20.5	18.5	17	14.5
CHS20-30	4	5.5		39.5	39	38	37.5	35.5	34	31.5	29	26	23

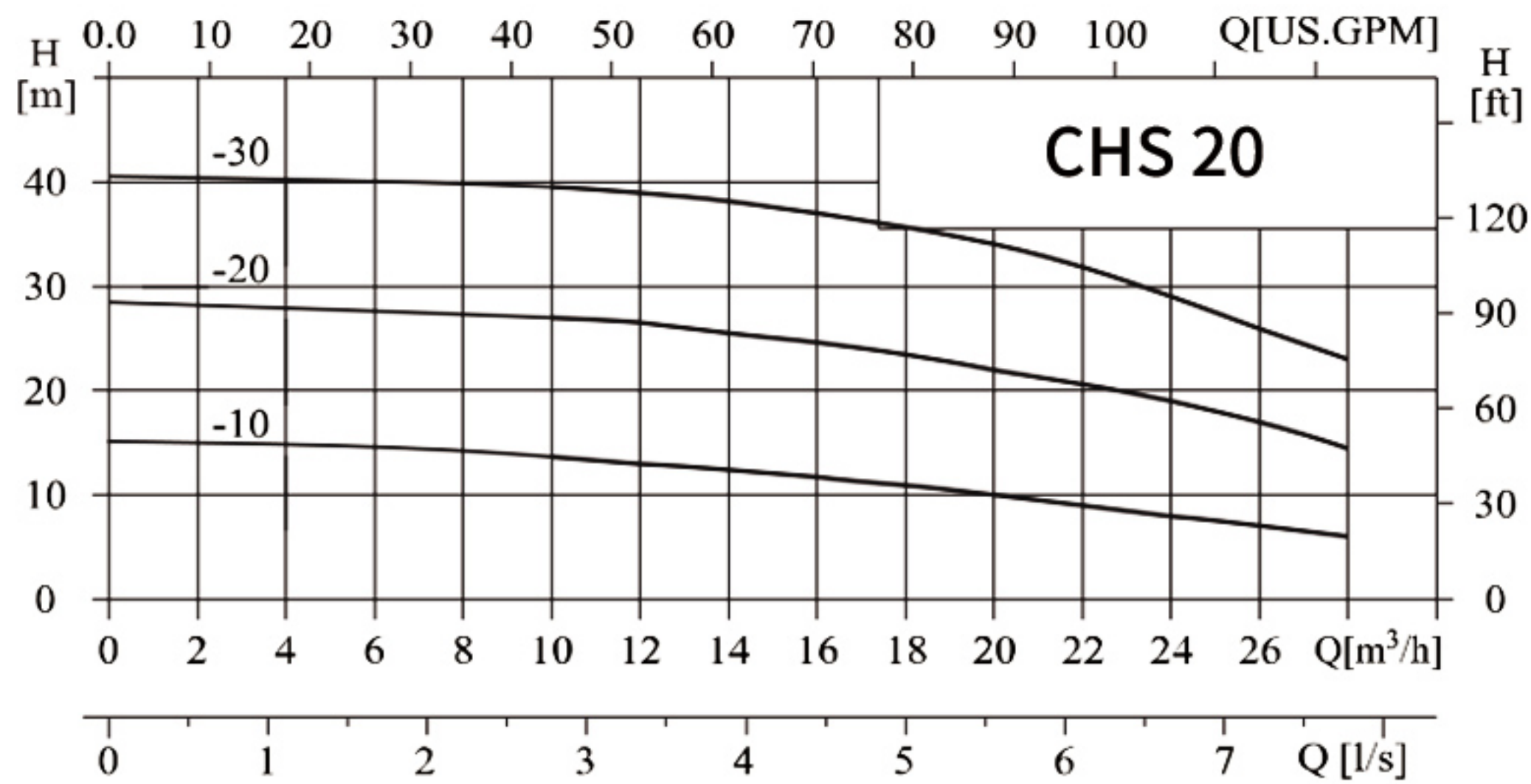

● Installation sketch

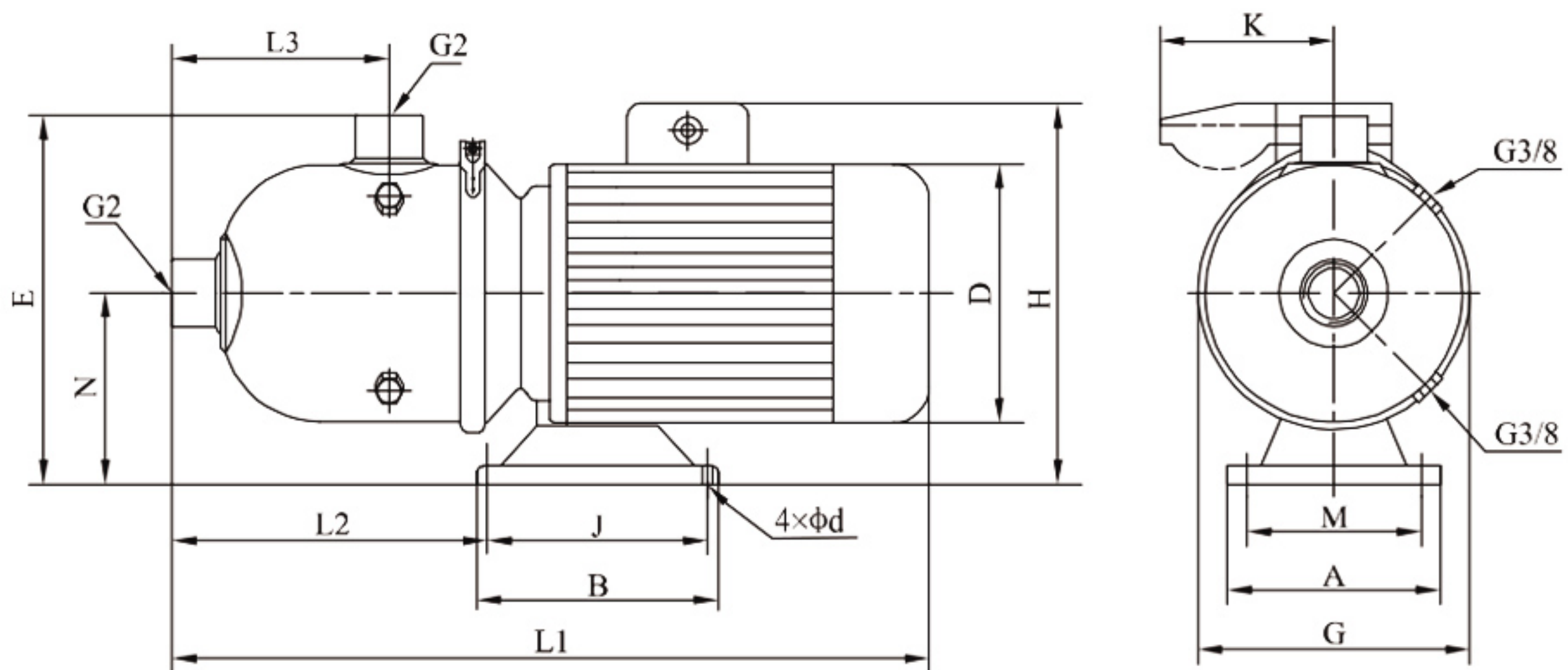

● Size and weight

Motor	Model	Size (mm)														Weight (kg)
		L1	L2	L3	N	E	G	A	M	B	J	d	D	H	K	
Three-phase/ single-phase	CHS20-10	530	279	176	117	264	223	130	108	160	138	9	151/161	230/265	/91	20
	CHS20-20	563	279	176	118	265	223	130	108	160	138	9	171/176	235/270	/91	26
	CHS20-30	612	357	176	120	267	223	220	190	170	140	12	213/	270/		40

CHS 2 60HZ

● Performance table

Model	Driving motor		Q (m ³ /h)	1	1.5	2	2.5	3	3.5	4
	(kW)	(hp)								
CHS2-20	0.55	0.75	H (m)	24.5	23	21.5	19.5	17	14	10.5
CHS2-30	0.75	1		37.5	35.5	33	30.5	27.5	23.5	19
CHS2-40	1.1	1.5		49.5	48	45.5	42	36	32	26
CHS2-50	1.1	1.5		62	58.5	55	51	46	40.5	33
CHS2-60	1.1	1.5		73.5	70.5	66	61.5	56	49	40

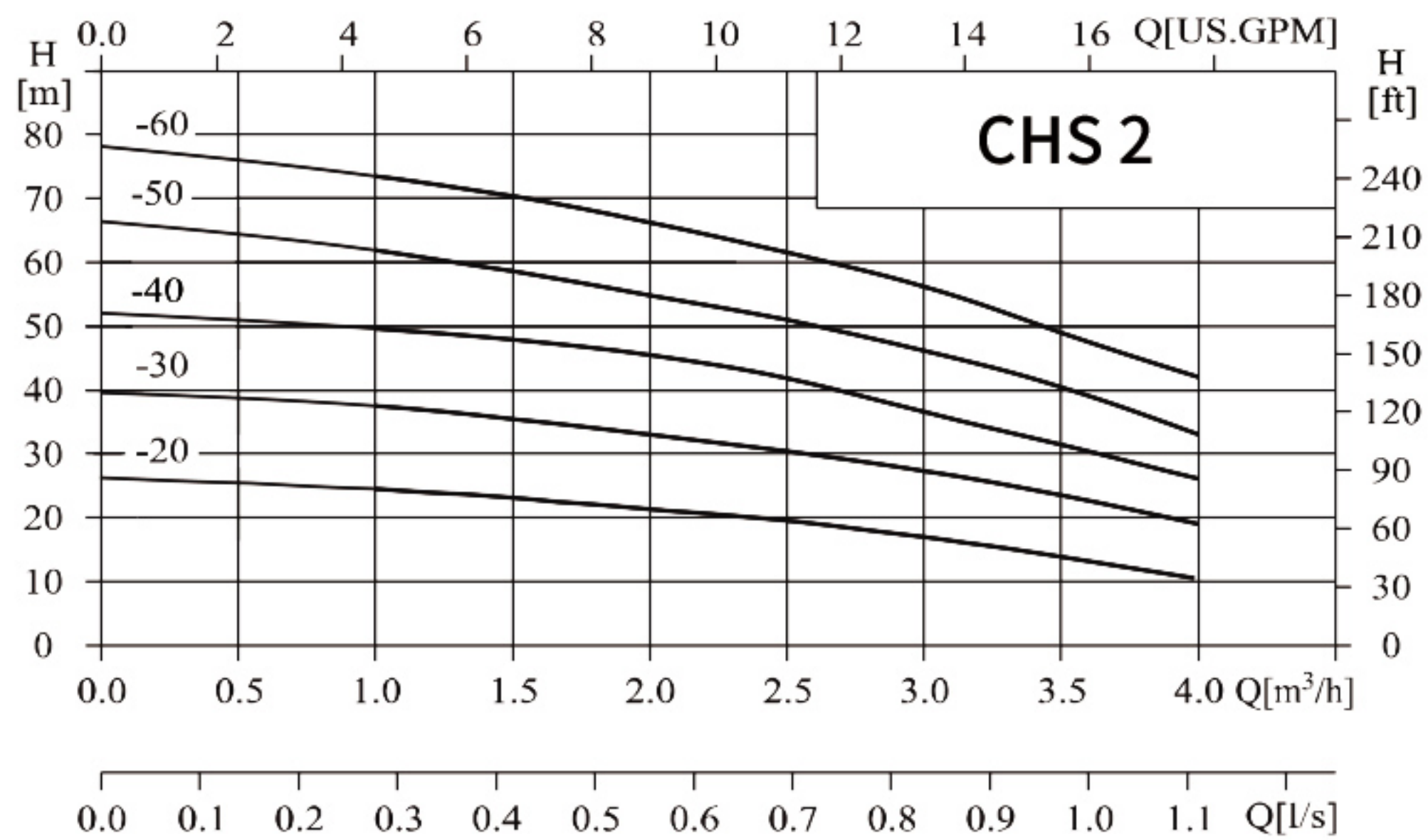

● Installation sketch

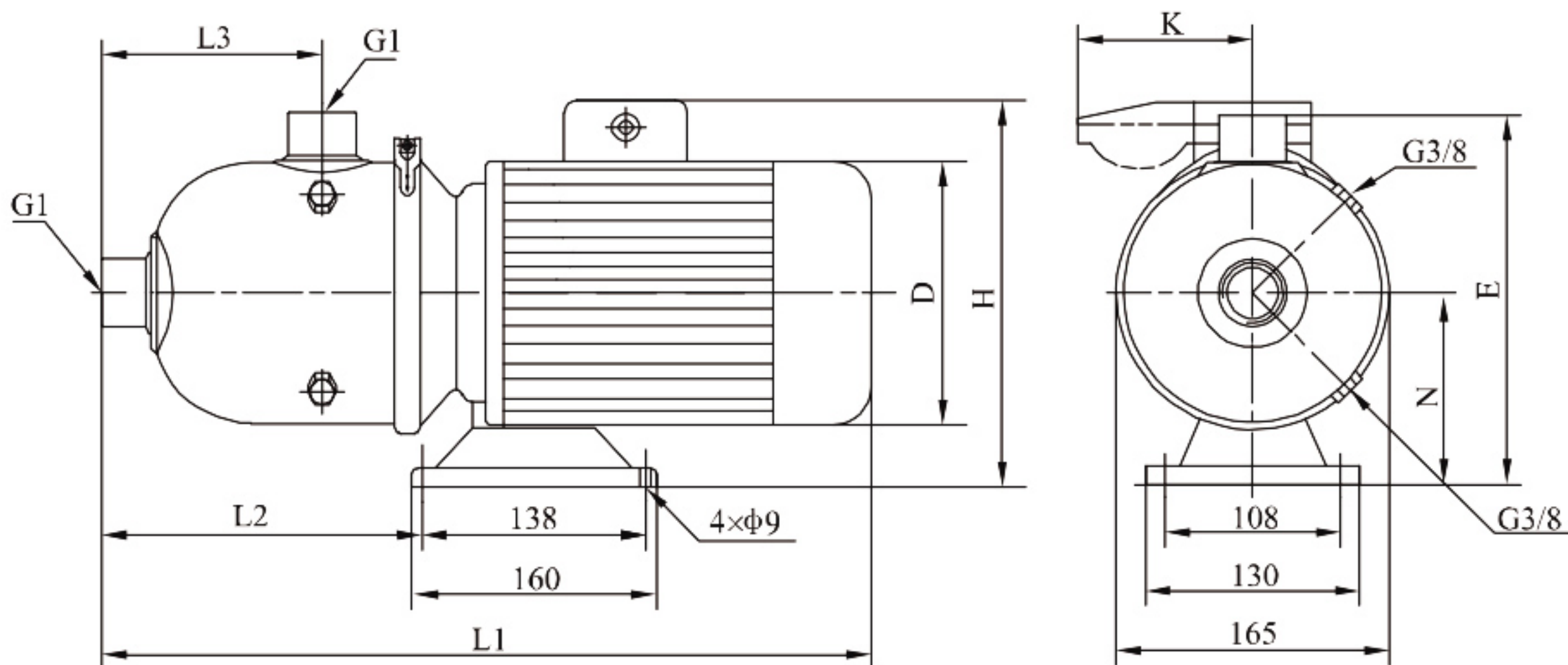

● Size and weight

Motor	Model	Size (mm)								Weight (kg)
		L1	L2	L3	H	N	D	E	K	
Three-phase/ single-phase	CHS2-20	400	165	125	215/249	110	141	215	/62	13
	CHS2-30	420	165	125	230/265	110	151/161	215	/91	13
	CHS2-40	420	165	125	230/265	110	151/161	215	/91	15
	CHS2-50	420	165	125	230/265	110	151/161	215	/91	15
	CHS2-60	420	165	125	230/265	110	151/161	215	/91	15

CHS 4 60HZ

● Performance table

Model	Driving motor		Q (m ³ /h)	2	3	4	5	6	7	8
	(kW)	(hp)								
CHS4-20	0.75	1	H (m)	26	25	23	21	19	16	14
CHS4-30	1.1	1.5		39	37.5	36	32	28	24	21
CHS4-40	1.5	2		52	50	47	43.5	38.5	35	31

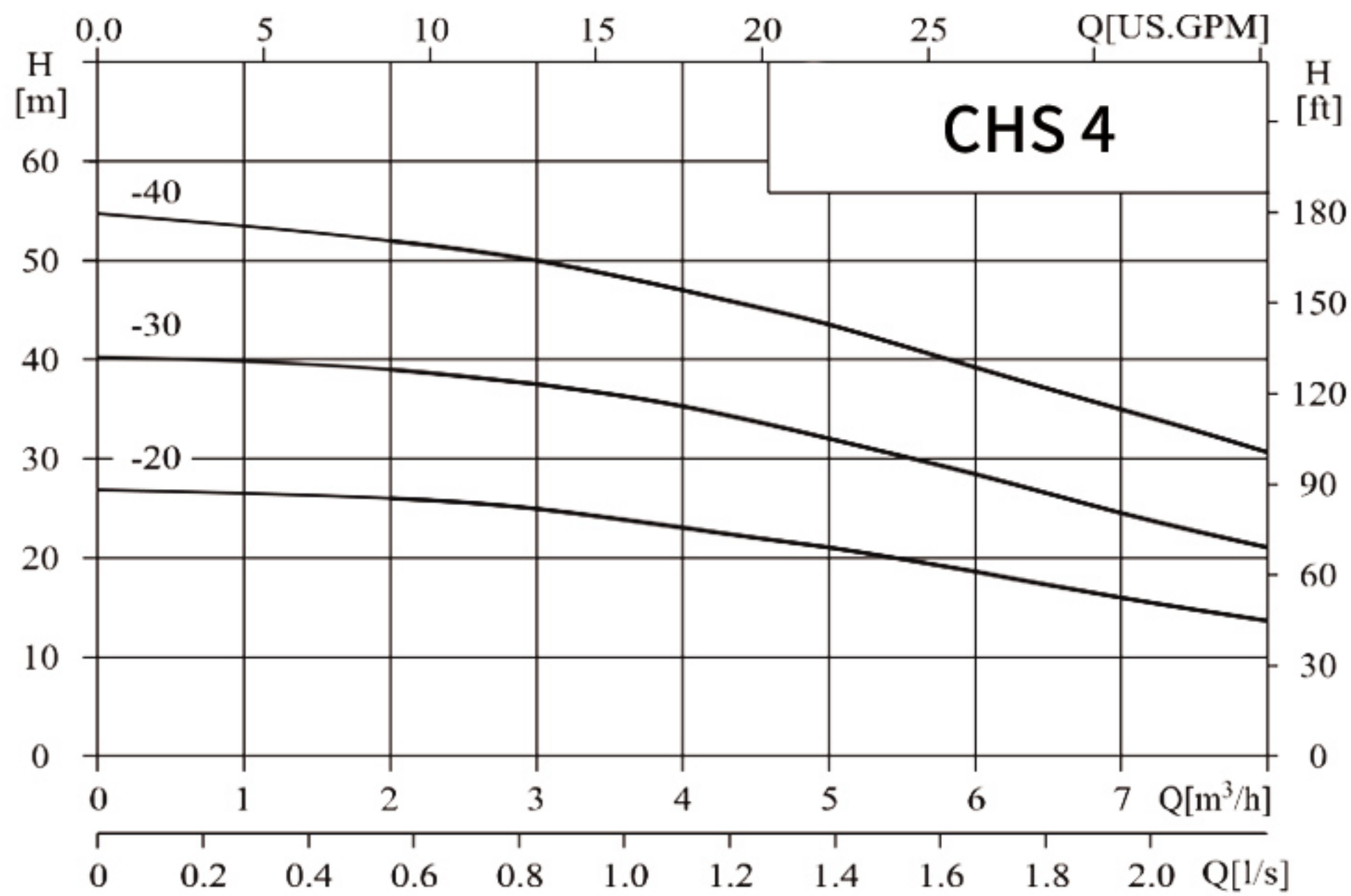

● Installation sketch

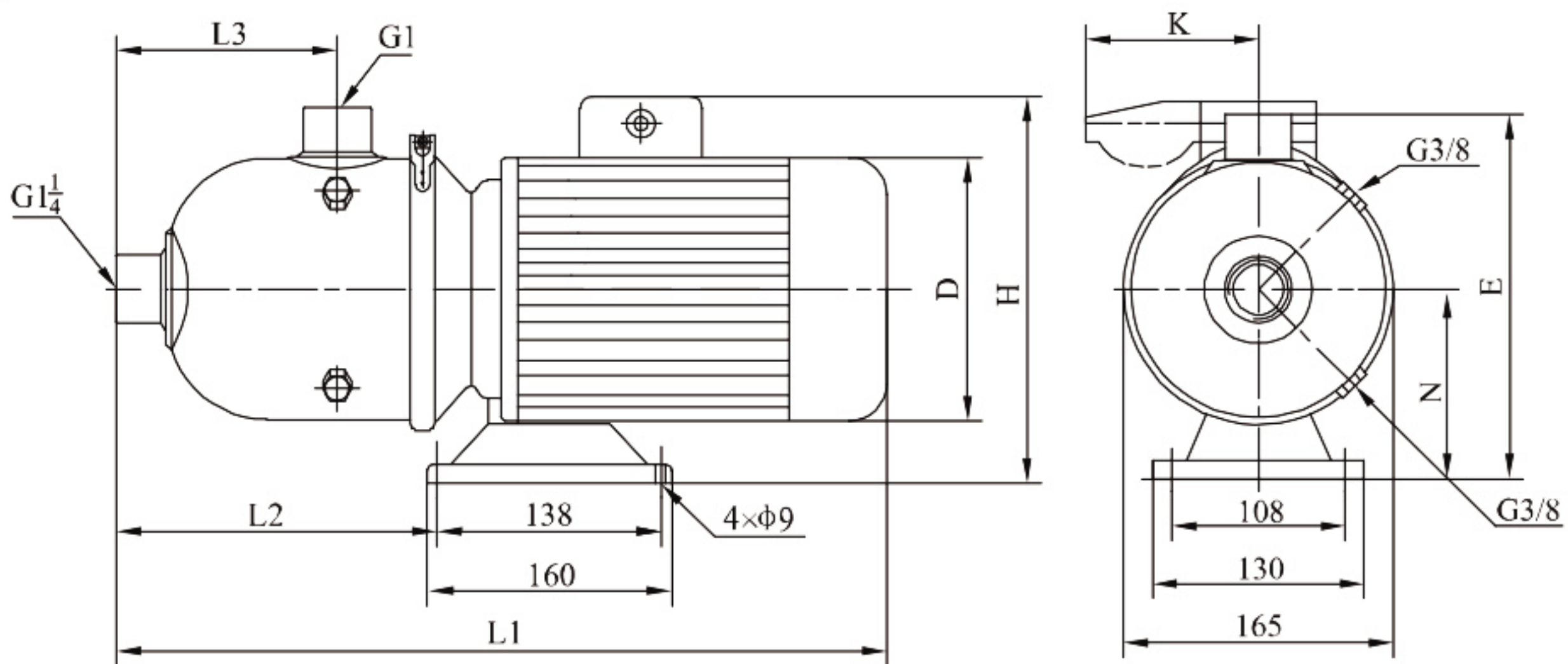

● Size and weight

Motor	Model	Size (mm)								Weight (kg)
		L1	L2	L3	H	N	D	E	K	
Three-phase/ single-phase	CHS4-20	420	172	132	230/265	110	151/161	215	/91	12
	CHS4-30	420	172	132	230/265	110	151/161	215	/91	15
	CHS4-40	470	172	132	235/270	110	171/176	215	/91	20



CNC PUMP

※本公司有變更資料之權利，訂購前請先電話確認。

CHS 8 60HZ

● Performance table

Model	Driving motor		Q (m ³ /h)	6	7	8	9	10	11	12	13
	(kW)	(hp)									
CHS8-10	0.75	1	H (m)	14.5	13	12	11.5	11	10.5	10	9.5
CHS8-20	1.5	2		29	27	26	25	24	23	21.5	20
CHS8-30	2.2	3		42	41	40	39	37	35	33	30
CHS8-40	3	4		55.5	54.5	53	51	49	46.5	43.5	40
CHS8-50	3	4		71	69.5	67.5	65	63	59	56	52

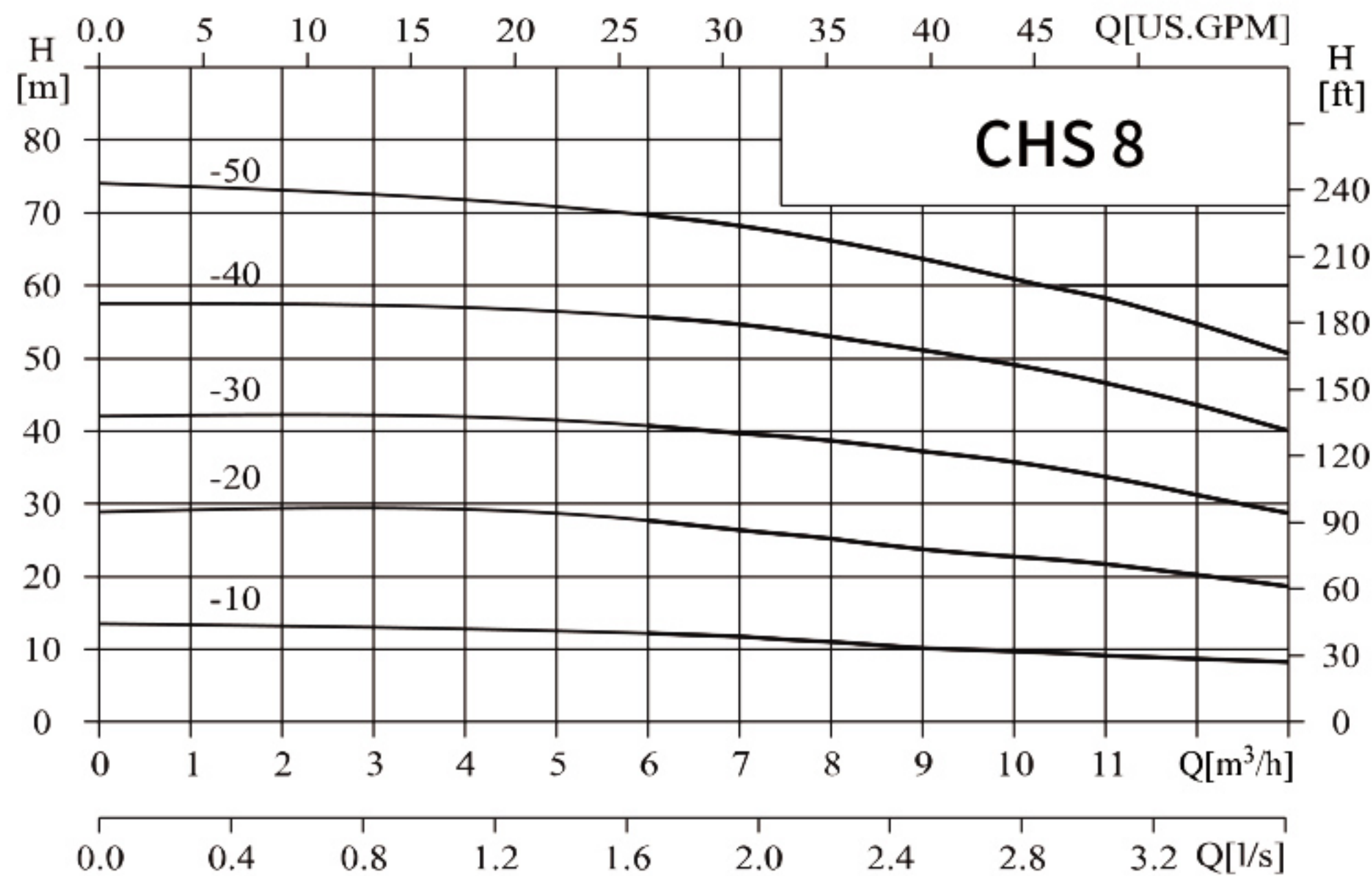

● Installation sketch

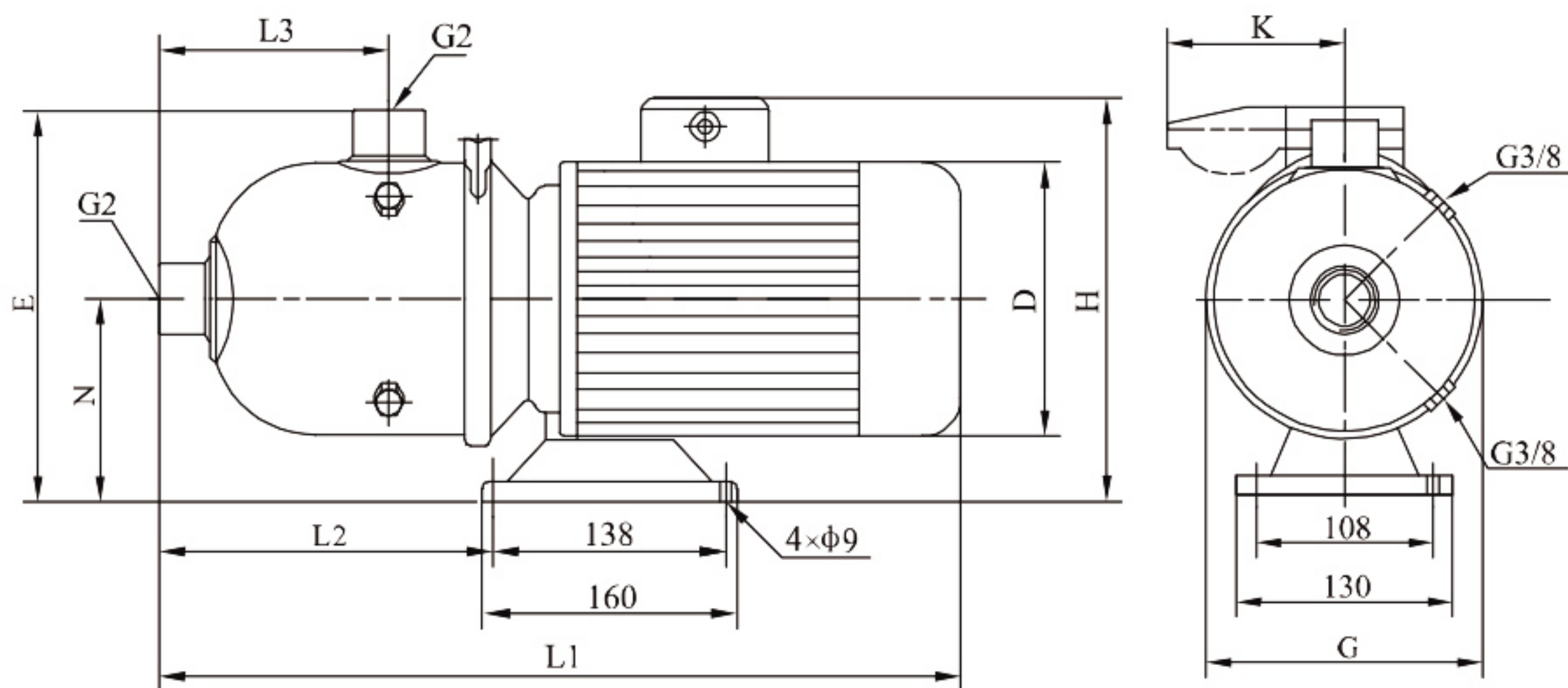

● Size and weight

Motor	Model	Size (mm)									Weight (kg)
		L1	L2	L3	N	E	G	D	H	K	
Three-phase/ single-phase	CHS8-10	530	279	176	117	264	223	151/161	230/265	/91	20
	CHS8-20	563	279	176	118	265	223	171/176	235/270	/91	25
	CHS8-30	563	279	176	118	265	223	171/176	235/270	/91	25
	CHS8-40	605	269	176	128	275	223	196/	259/		30
	CHS8-50	605	269	176	128	275	223	196/	259/		30

CHS 12 60HZ

● Performance table

Model	Driving motor		Q (m ³ /h)	7	9	11	12	13	15	17	19
	(kW)	(hp)									
CHS12-10	1.1	1.5	H (m)	17	16	15	14.5	14	12.5	11	8.5
CHS12-20	2.2	3		34	33	32	31	30	27	24.5	19
CHS12-30	3	4		52.5	50	48.5	47	45	41.5	37.5	29
CHS12-40	4	5.5		69	67.5	65	63	60.5	55	49.5	40
CHS12-50	5.5	7.5		88	85	82	80	76	70	62	50.5

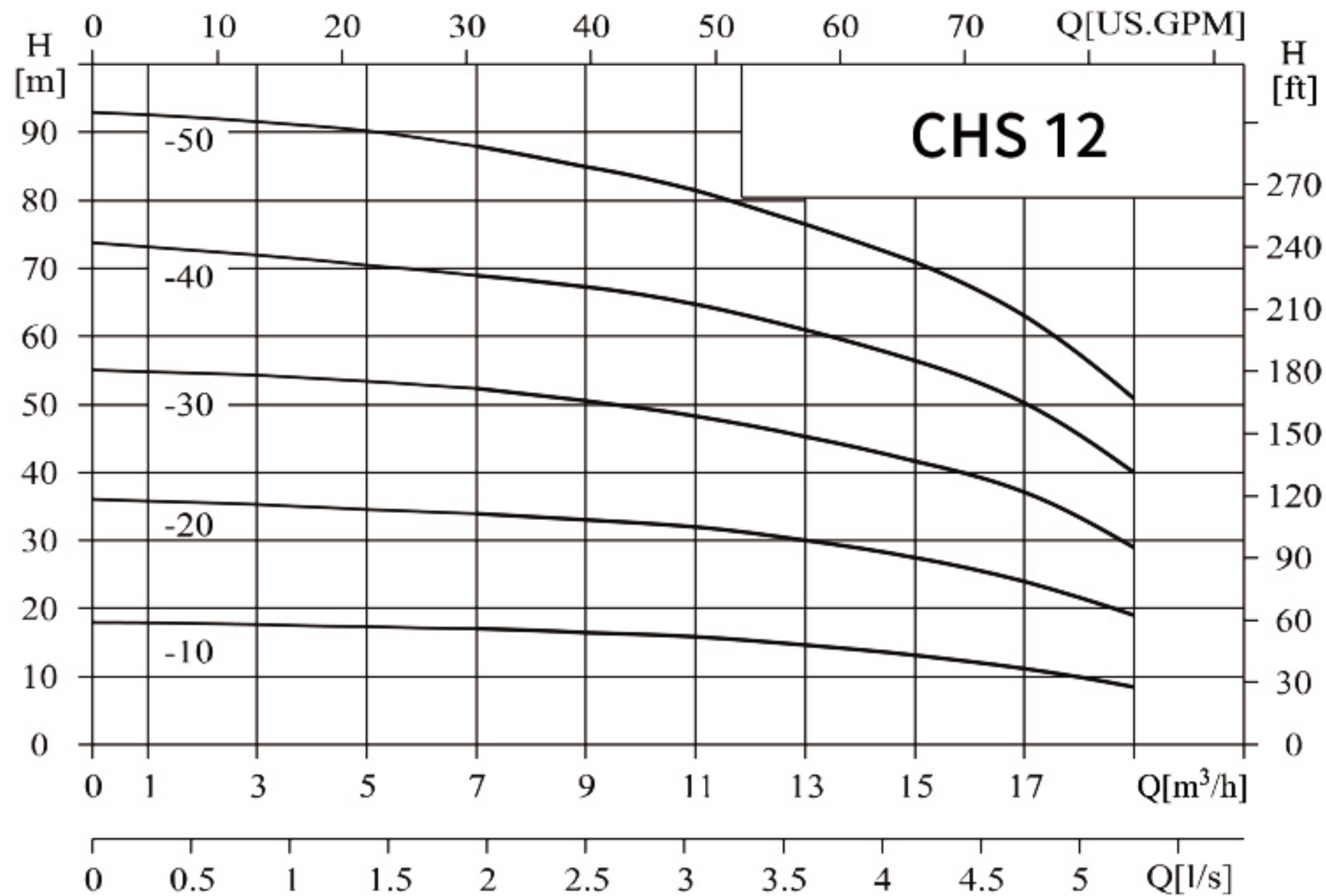

● Installation sketch

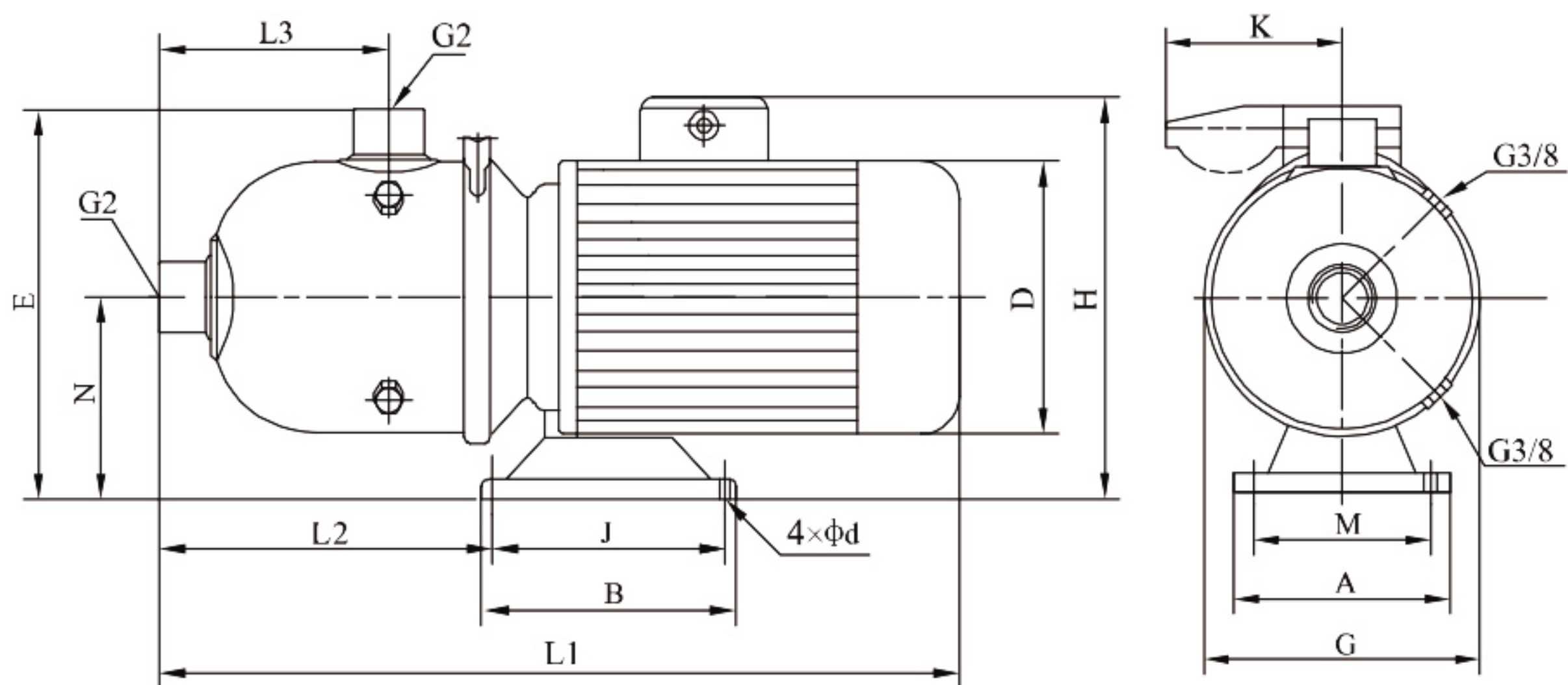

● Size and weight

Motor	Model	Size (mm)														Weight (kg)
		L1	L2	L3	N	E	G	A	M	B	J	d	D	H	K	
Three-phase/ single-phase	CHS12-10	530	279	176	117	264	223	130	108	160	138	9	151/161	230/265	/91	22
	CHS12-20	563	279	176	118	265	223	130	108	160	138	9	171/176	235/270	/91	25
	CHS12-30	612	279	176	118	265	223	130	108	160	138	9	196/	259/		32
	CHS12-40	612	357	176	120	267	223	220	190	170	140	12	213/	270/		44
	CHS12-50	661	369	176	132	279	223	248	216	190	140	12	255/	300/		58

CHS 15 60HZ

● Performance table

Model	Driving motor		Q (m ³ /h)	10	12	14	15	16	18	20	22	24	26
	(kW)	(hp)		H (m)									
CHS 15-10	1.5	2		17	15.5	14.5	14	13.5	13	12	11	10	9
CHS 15-20	3	4		35.5	34.5	33.5	33	32.5	31	30	28	26	23
CHS 15-30	4	5.5		55	53.5	52.5	51.5	51	49	47	44	41	36.5

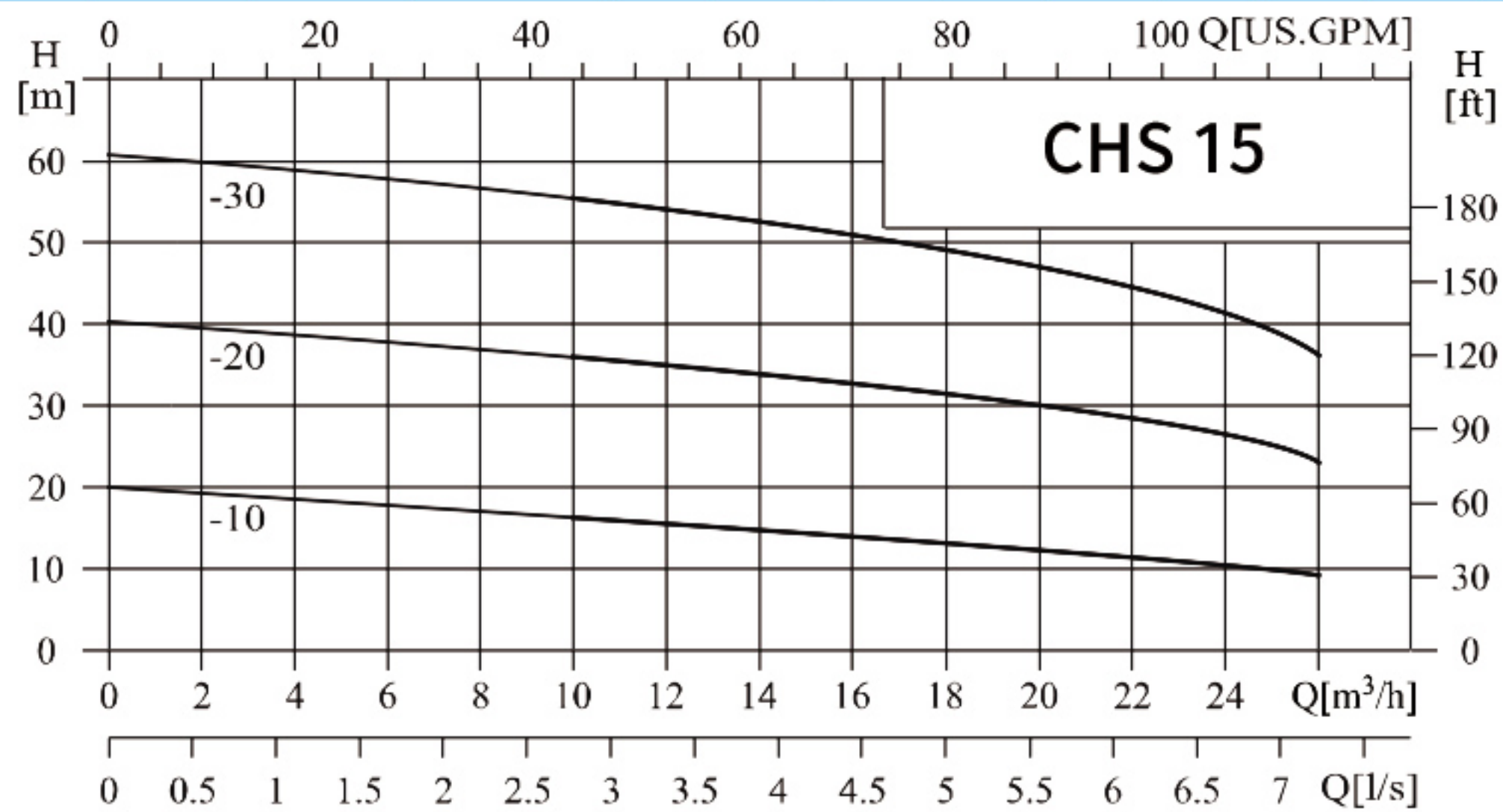

● Installation sketch

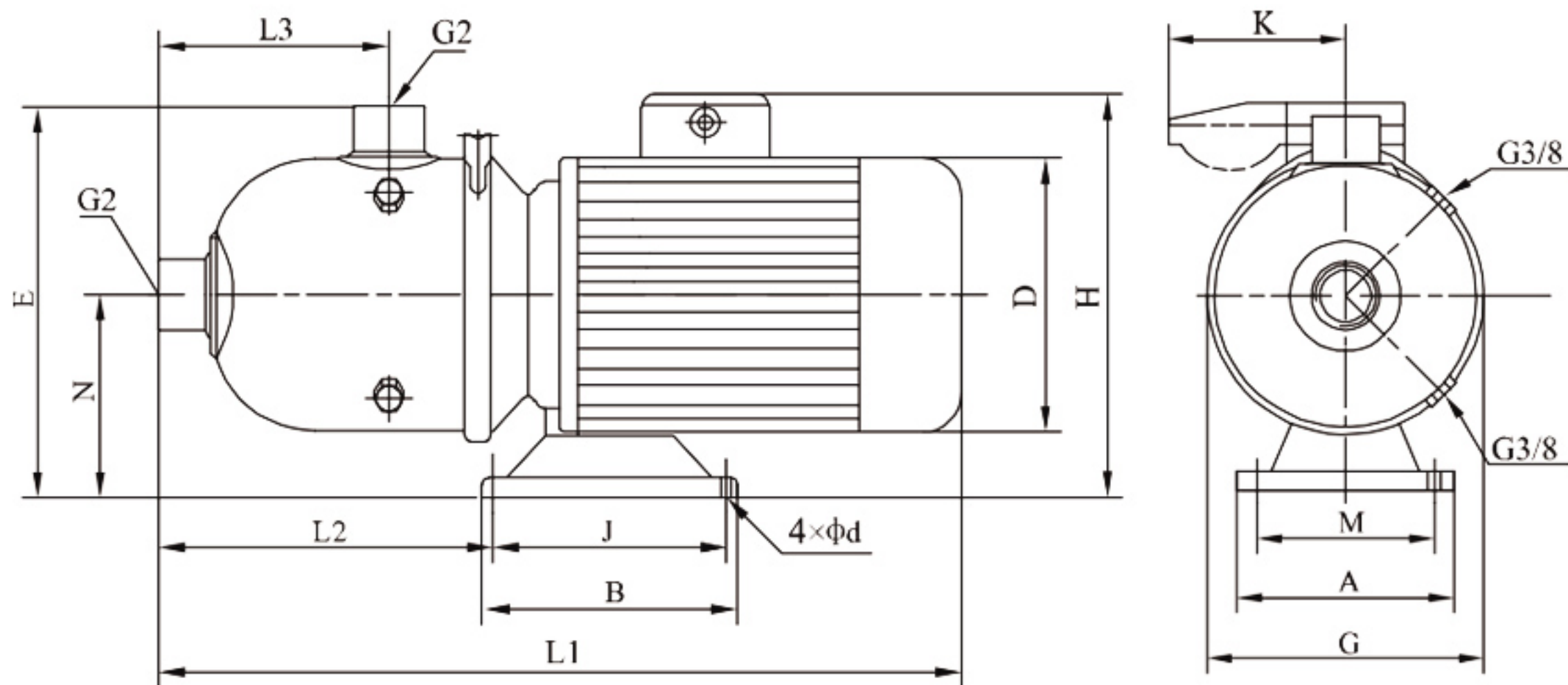

● Size and weight

Motor	Model	Size (mm)														Weight (kg)
		L1	L2	L3	N	E	G	A	M	B	J	d	D	H	K	
Three-phase/ single-phase	CHS 15-10	563	279	176	118	264	223	130	108	160	138	9	171/176	235/270	/91	23
	CHS 15-20	605	279	176	128	274	223	130	108	160	138	9	196/	259/		32
	CHS 15-30	612	357	176	120	266	223	220	190	170	140	12	213/	270/		45



CNC PUMP

※本公司有變更資料之權利，訂購前請先電話確認。

CHS 20 60HZ

● Performance table

Model	Driving motor		Q (m ³ /h)	12	14	16	18	20	22	24	26	28	30	32
	(kW)	(hp)												
CHS20-10	2.2	3	H (m)	19	18.5	18	17.5	17	16	15	13.5	12	11	10
CHS20-20	4	5.5		38	37	36	35	34	33	32	30.5	29	26.5	24
CHS20-30	5.5	7.5		58	57	56	55	53	51.4	50	47.5	45	41.6	38

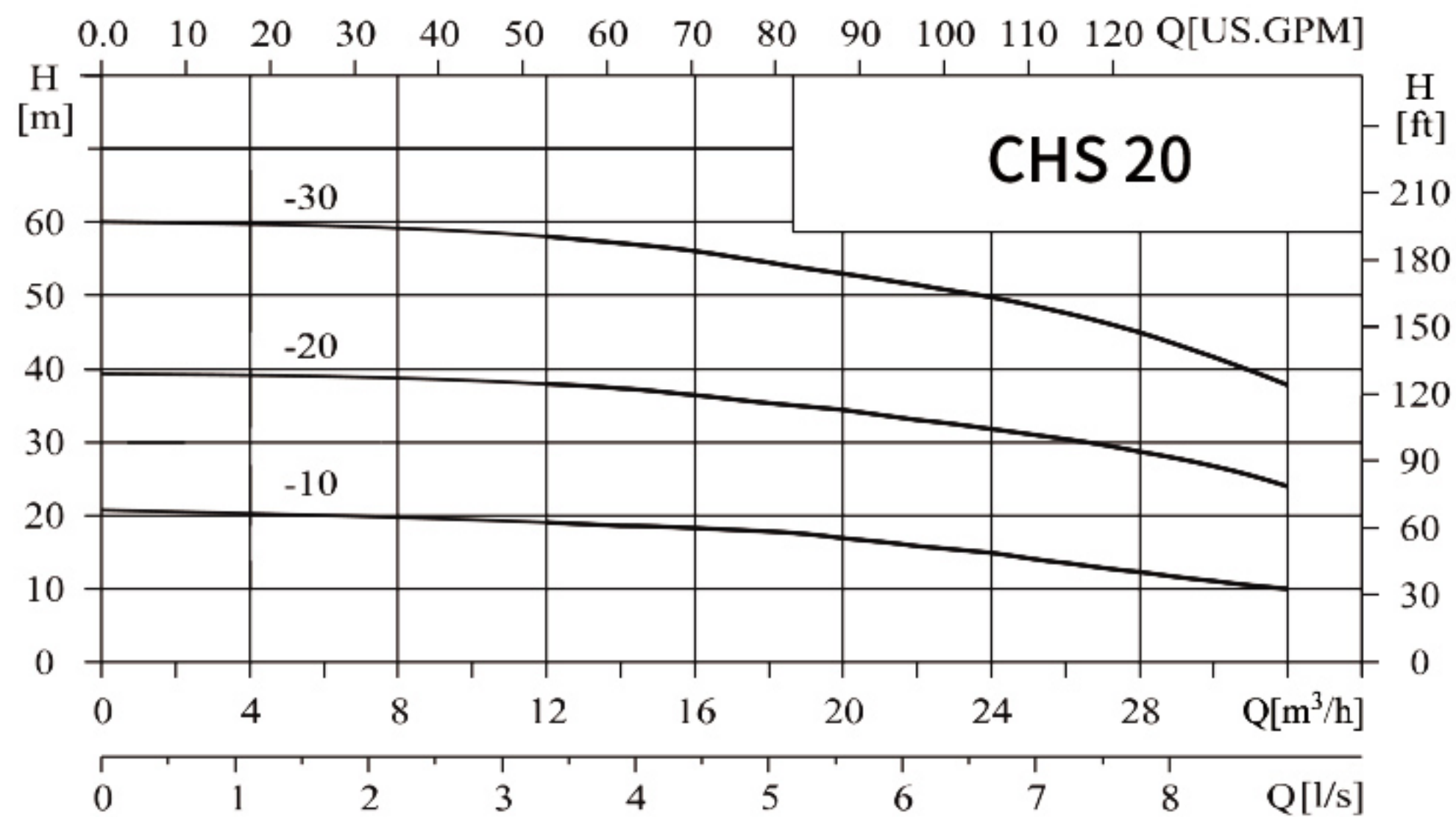

● Installation sketch

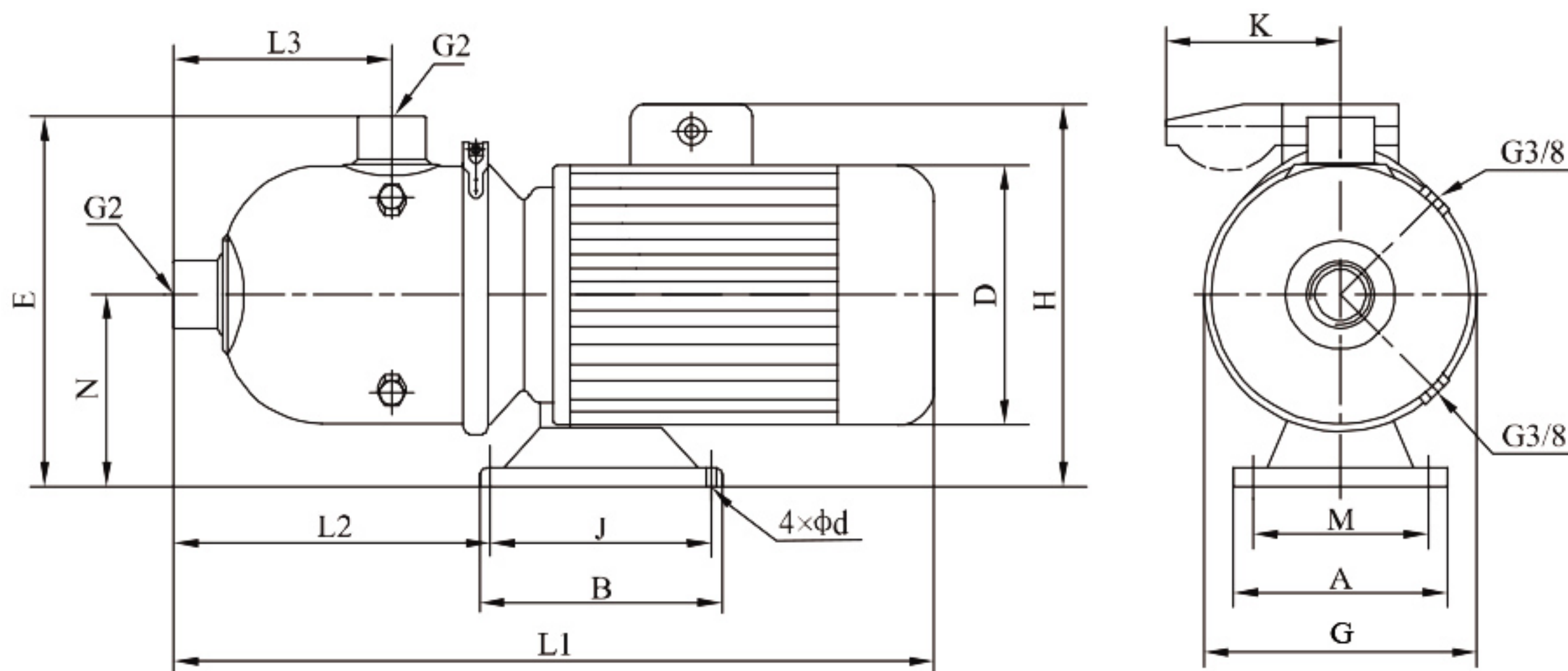

● Size and weight

Motor	Model	Size (mm)														Weight (kg)
		L1	L2	L3	N	E	G	A	M	B	J	d	D	H	K	
Three-phase/ single-phase	CHS20-10	563	279	176	118	265	223	130	108	160	138	9	171/176	235/270	/91	26
	CHS20-20	612	357	176	120	267	223	220	190	170	140	12	213/	270/		43
	CHS20-30	661	369	176	132	279	223	248	216	190	140	12	255/	300/		56

