

Upon consultation, please specify any of the following items:

Request for Information

In sending your enquiry or order please furnish us with the following informations in detail

1. Liquid: _____
2. Capacity: _____ M /Min.³ (US.GPM)
3. Total head: _____ M(ft)
4. Temperature of liquid: _____ °C(°F)
5. Liquid viscosity: _____
6. Specific gravity: _____
7. PH: _____
8. NPSH available: _____ M(ft)
9. Pump speed: _____ rpm
10. Rated power: _____ kW(HP), _____ Pole _____ phase, _____ Hz, _____ volts

Main products

- General water supply and drainage pump
- Air conditioning and refrigeration pump
- Boiler water supply high pressure pump
- Pump for delivery of liquid containing solid impurities
- Petrochemical liquid process delivery pump
- Acid/alkaline liquid delivery pump
- Deep well water pump
- Hot kerosene delivery pump
- Vertical/horizontal multi-stage centrifugal pump
- Sanitary centrifugal, rotor pump

Main Products

PUMP FOR INDUSTRY
PUMP FOR PROCESS
PUMP FOR CHEMICAL ENGINEERING
PUMP FOR PAPER STOCK
PUMP FOR AGRICULTURE
PUMP FOR DEEPWELL
PUMP FOR FOOD
PUMP FOR MEDICINE

Pumps of various special purposes

Case-by-case commissioned design and manufacturing

Professional manufacturer of various pumps

DA CHUAN PUMP INDUSTRIAL CO., LTD.

<http://www.cnc-pump.com.tw>

TEL: (02) 2847-6261 FAX: (02) 2289-1677

E-mail: cncpump@yahoo.com.tw



CHUNG CHUAN PUMP



Back-pull-out design

End Suction Centrifugal Pump

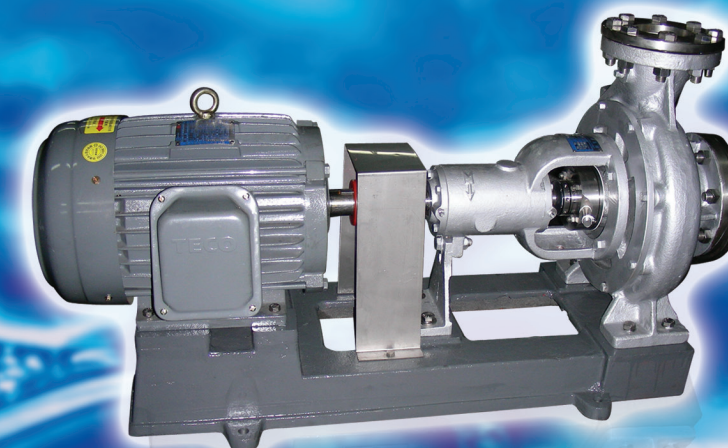

Trustworthy • Professional • Creative

<http://www.cnc-pump.com.tw>

Professional Pump Maker!

ISO 9001:2008, CNS12681

Company with international certificates

ISO 14001 Environmental
Quality Assurance Certificate



BS End Suction Centrifugal Pump

Model: BS Max. Head: 120M Max. Capacity: 22 m³/min Discharge: 1"-14" Motor Power: 1 -200 HP

Structure description

1. This pump is based on the back-pull-out design, which allows you to easily pull out impeller, middle level seat, and shaft seal without removing pump case and inlet/outlet pipelines. The pump outlet is located on the central line to simplify the connection of pipes to allow automatic pump exhaust.
2. There are two strong ball bearings in the bearing frame which can be lubricated by machine oil or lubricant. The bearing is made by international renowned manufacturer, and the thrust load can be evenly distributed between two bearings to reduce the wear and to prolong the service life of bearing.
3. There are feet designed for the pump case which are casted along with the pump case. It can provide very stable support beneath the center of pump case to prevent central line from distortion and deformation. The pump body and pump case are made of grey cast iron, and there are soft filler or mechanical shaft seal. The shaft sleeve is made of stainless steel, and the supporting frame is made of grey cast iron which can serve as the auxiliary support for the bearing frame.
4. The shaft seal design can be based on appropriate approach according the place of use. For example, filler, general water mechanical shaft seal, and chemical engineering dual mechanical shaft seal can all guarantee that the fluid will not be leaked.
5. The impeller structure is sealed type with extraordinary superior performance and suction. Every impeller is calibrated by balance test, and during operation there is low noise, small vibration, and high efficiency. The design of back blade or balance hole can reduce the shaft thrust and prolong service life. There is also semi-open impeller as an option.
6. This pump is equipped with simply structure, reliable performance, compact size, light weight, high suction, low power consumption, and convenient use and maintenance. The pump can be made of either cast iron, gun metal, alloy steel, or stainless steel, and it can be manufactured according to the needs or customer requirements.
7. The working temperature ranges from -40°C~300°C depending on the material.

Application

BS pump is for supply of clear water or the liquid with physical and chemical properties similar to water. It is applicable to:

- Water supply for urban buildings
- Water supply for hospital and school
- Delivery of chemical agent
- Sewage treatment equipment
- Water for industrial process
- Water supply for civil engineering
- Water supply for air conditioning circulation
- Water supply for boiler
- Deliver of hot kerosene
- Delivery of gasoline and diesel
- General industrial water
- Water for agricultural irrigation
- Delivery of refrigerant
- Water supply for cooling circulation

Instructions

1. The work rotational direction should be clockwise viewing from the driving end.
2. The lubricant in the bearing housing should be refilled once every 1000 working hours or two months. It should be filled up to 50% of the volume to avoid overheating of bearing.
3. There is greater amount of leakage of Stuffing box at the beginning of operation. Then it should be gradually fastened until the leakage reaches a proper level (less than 10 cc per minute).
4. The temperature increase of Stuffing box should not be greater than 40°C.
5. The bearing temperature should be kept under 80°C. (The cap of temperature increase is at room temperature plus 40°C)



Construction

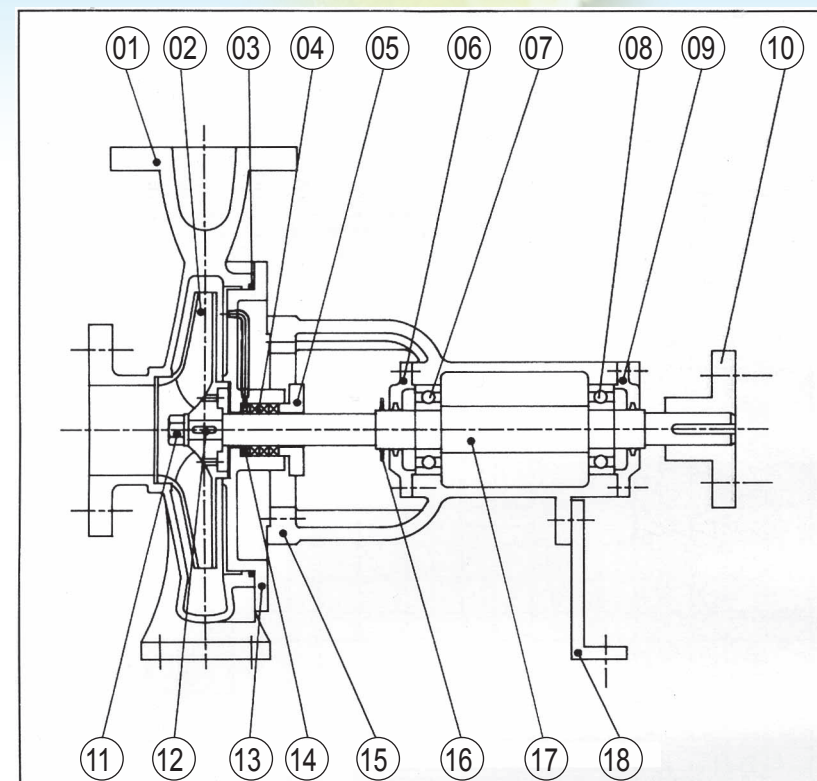

Parts list

Number	Part Name	Material			
		A	B	C	D
01	Pump casing	FC20	FC20	SCS13	SCS14
02	Impeller	BC6	BC6	SCS13	SCS14
03	O-ring	RUBBE	RUBBER	V#1500	V#1500
04	Gland packing	R	V#133	V#7133	V#7133
05	Gland	V#133	FC20	SCS13	SCS14
06	Bearing cover	FC20	FC20	FC20	FC20
07	Bearing	FC20	KOYO	KOYO	KOYO
08	Bearing	KOYO	KOYO	KOYO	KOYO
09	Bearing cover	KOYO	FC20	FC20	FC20
10	Coupling	FC20	FC20	FC20	FC20
11	Impeller lock nut	FC20	BC6	SUS304	SUS316
12	Impeller key	BC6	SUS304	SUS304	SUS316
13	Lantern bracket	S25C	FC20	SCS13	SCS14
14	Cool ring	FC20	FC20	SCS13	SCS14
15	Bearing houseing	FC20	FC20	FC20	FC20
16	Flinger	FC20	RUBBER	RUBBER	RUBBER
17	Pump shaft	RUBBE	SUS410	SUS304	SUS316
18	Foot bridge	R	FC20	FC20	FC20
19	Bearing sleeve	S45C			
20	Mechanical seal	FC20			
21	Seal cover				

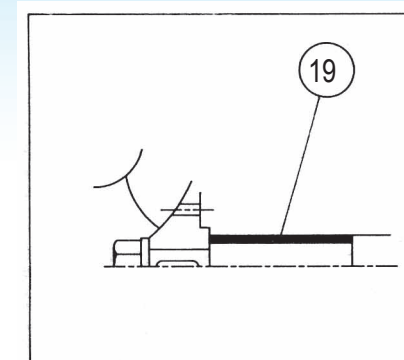

Shaft sleeve type

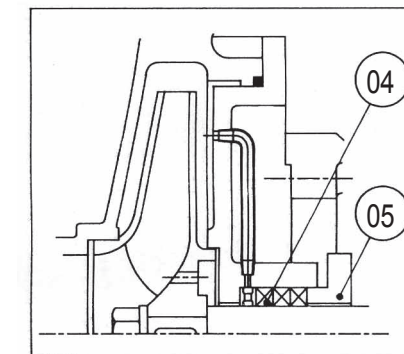

Soft Packing

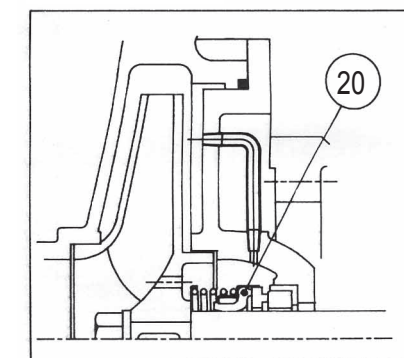

Clear water mechanical seal

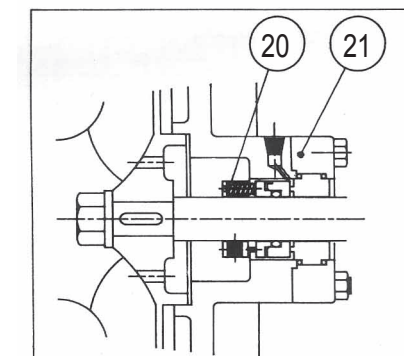

Chemical Mechanical seal



BS Dimension Diagram

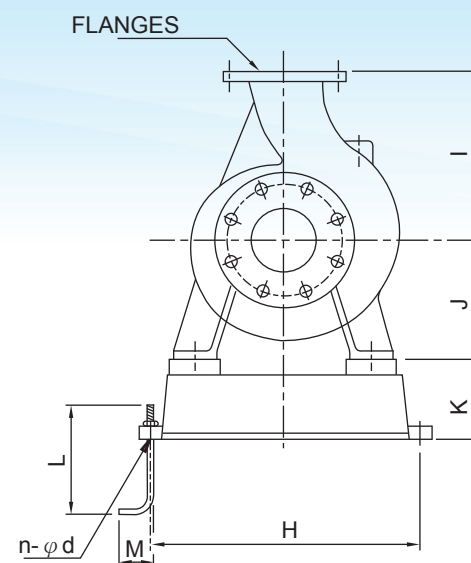
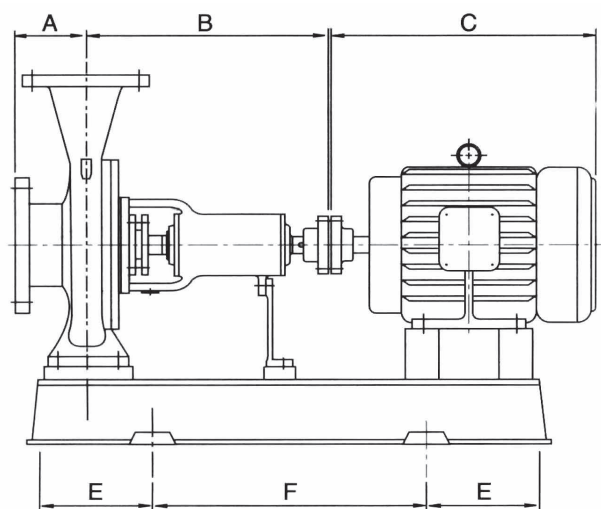

BS Dimension Table

TYPE	Discharge		A	B	J	I
	Inlet	Outlet				
BS25-130	40	25	80	360	112	140
BS25-160	40	25	80	375	132	160
BS25-200	40	25	80	410	150	180
BS25-260	40	25	100	360	180	225
BS40-130	50	40	80	360	112	1140
BS40-160	50	40	80	375	132	160
BS40-200	50	40	80	410	150	180
BS40-260	50	40	100	410	180	225
BS40-320	50	40	125	360	200	250
BS50-130	35	50	80	360	132	160
BS50-160	65	50	100	375	160	180
BS50-200	65	50	125	410	150	180
BS50-260	65	50	100	410	180	225
BS50-320	65	50	125	470	225	285
BS65-160	80	65	100	380	160	203
BS65-200	80	65	100	425	180	220
BS65-260	80	65	100	410	180	243
BS65-290	80	65	100	470	225	250
BS65-320	80	65	125	470	225	285
BS80-160	100	80	125	380	180	203
BS80-200	100	80	125	425	180	265
BS80-260	100	80	125	455	200	260
BS80-290	100	80	125	470	250	280
BS80-320	100	80	125	470	225	310
BS80-360	100	80	125	470	280	355
BS100-200	125	100	125	470	200	280
BS100-260	125	100	10	470	225	285
BS100-290	125	100	140	470	250	302

*Our company retains the right of data variation, so please call us for confirmation before purchase.

BS Dimension Diagram

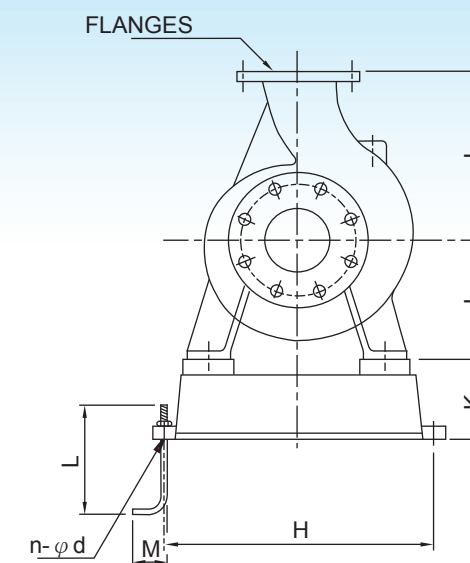
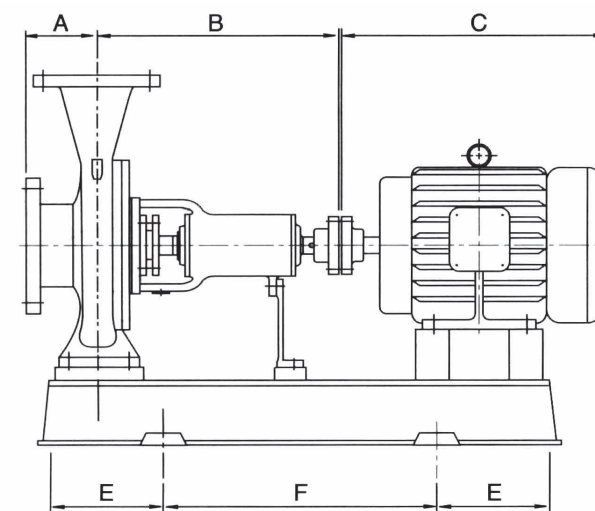

BS Dimension Table

TYPE	Discharge		A	B	J	I
	Inlet	Outlet				
BS100-320	125	100	140	570	280	360
BS100-400	125	100	140	530	280	355
BS125-200	150	125	140	470	250	300
BS125-260	150	125	140	470	250	350
BS125-290	150	125	140	470	250	350
BS125-320	150	125	140	570	280	360
BS125-400	150	125	140	530	315	400
BS125-500	150	125	164	616	375	525
BS150-260	200	150	180	530	280	400
BS150-290	200	150	180	530	280	400
BS150-320	200	150	180	585	315	385
BS150-400	200	150	160	530	315	450
BS150-500	200	150	160	615	375	525
BS200-260	250	200	180	550	315	325
BS200-290	250	200	180	530	280	420
BS200-320	250	200	180	575	300	390
BS200-360	250	200	215	590	375	475
BS200-400	250	200	180	690	400	525
BS-250-290	300	250	235	620	315	453
BS250-320	300	250	180	690	355	525
BS250-360	300	250	220	610	350	425
BS250-400	300	250	240	783	400	500
BS350-420	350	350	288	940	605	605
BS250-290	250	250	235	620	315	453
BS250-320	300	250	180	690	355	525
BS250-360	300	250	220	610	350	425
BS250-400	300	250	240	783	400	500
BS350-420	350	350	288	940	500	605

*Our company retains the right of data variation, so please call us for confirmation before purchase.



BS Performance Curve Diagram

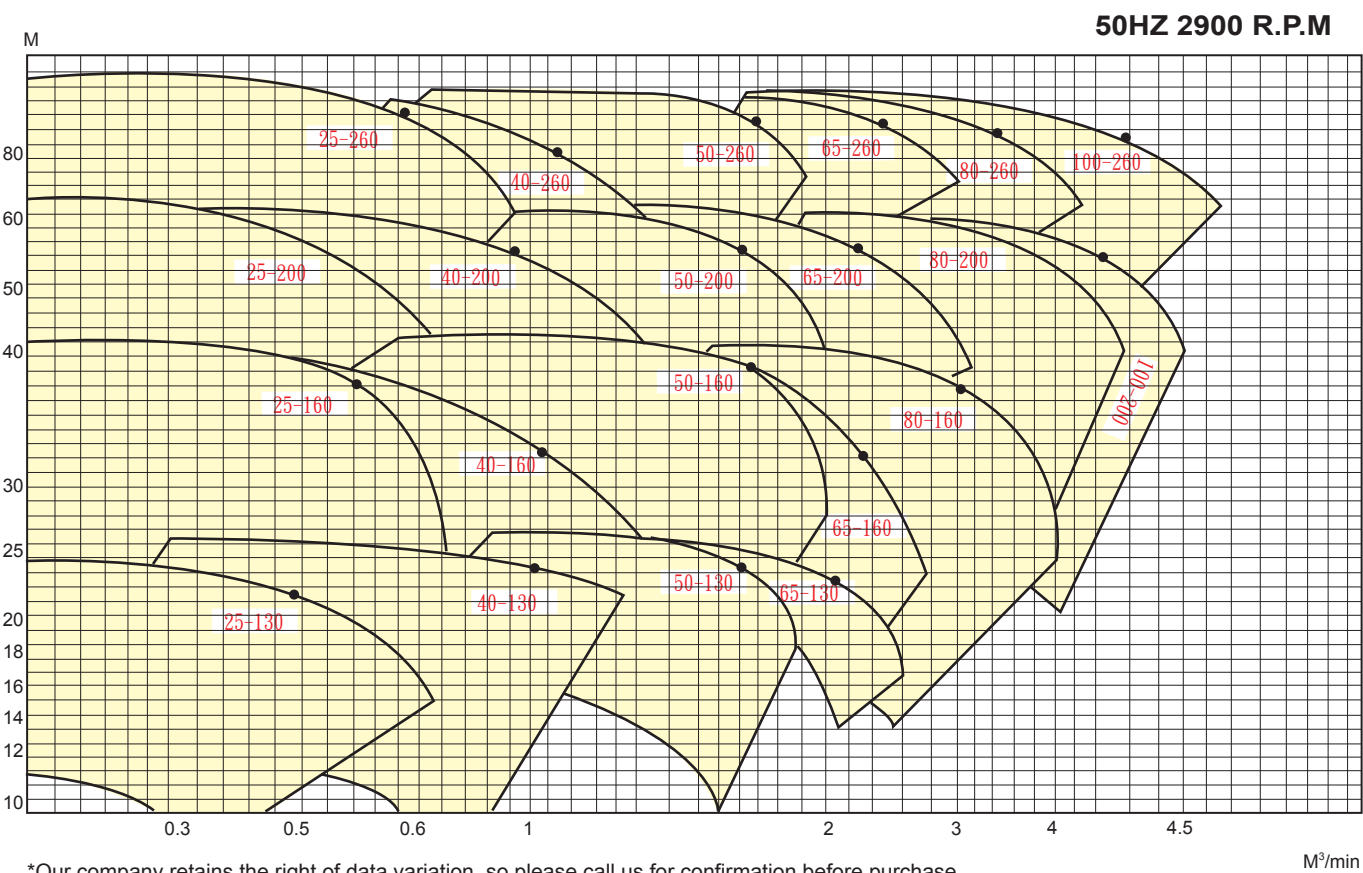
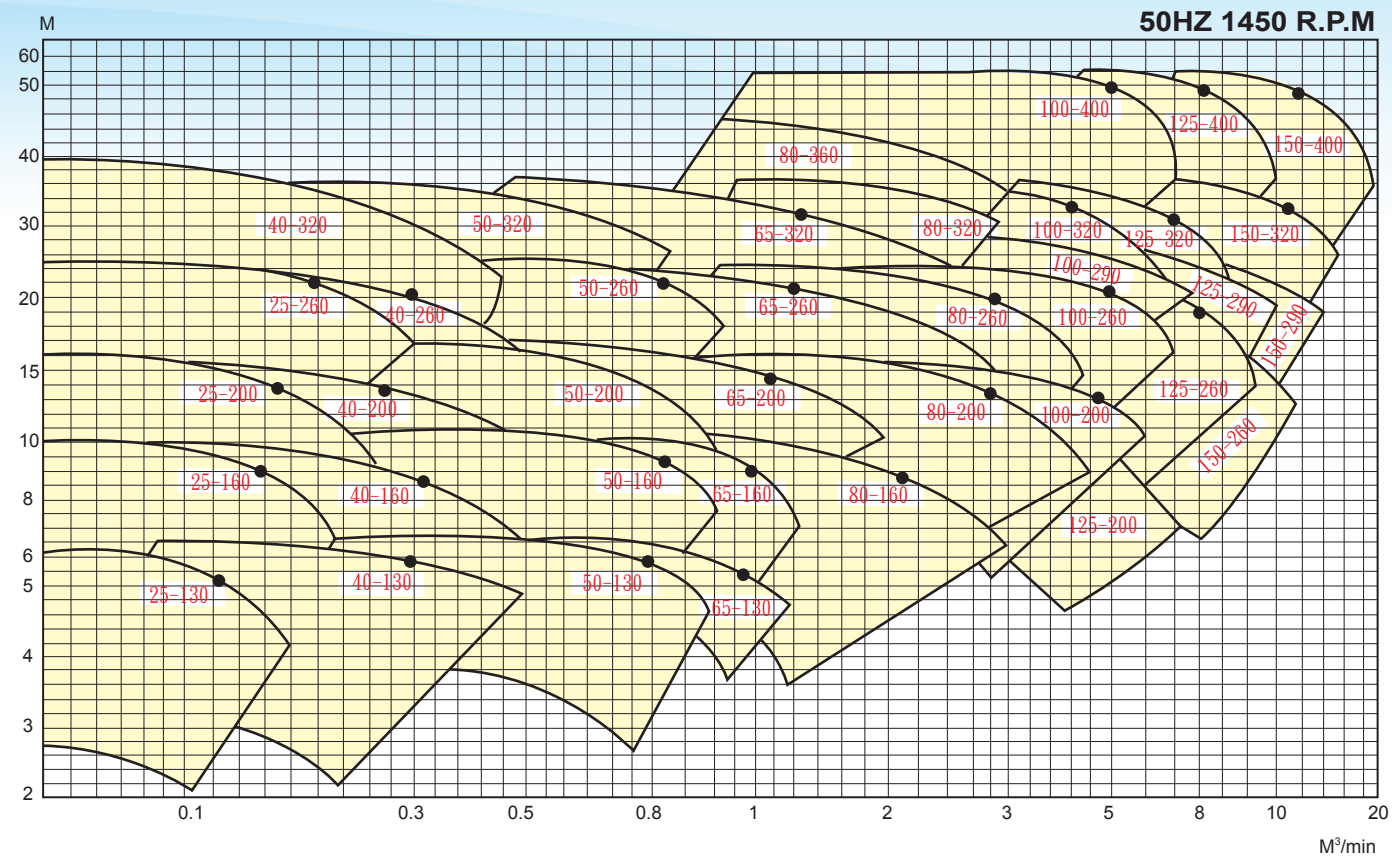

*Our company retains the right of data variation, so please call us for confirmation before purchase

BS Performance Curve Diagram

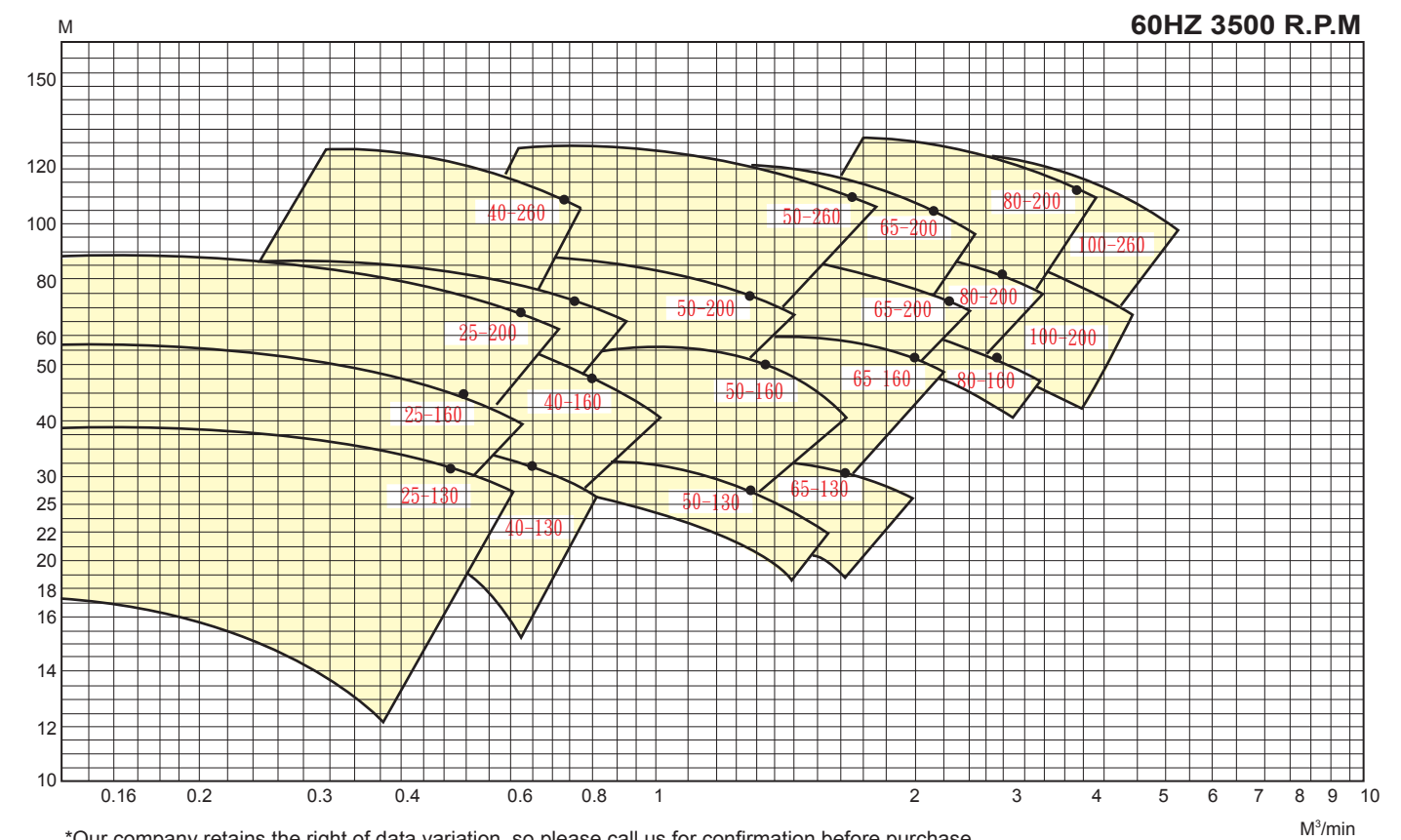
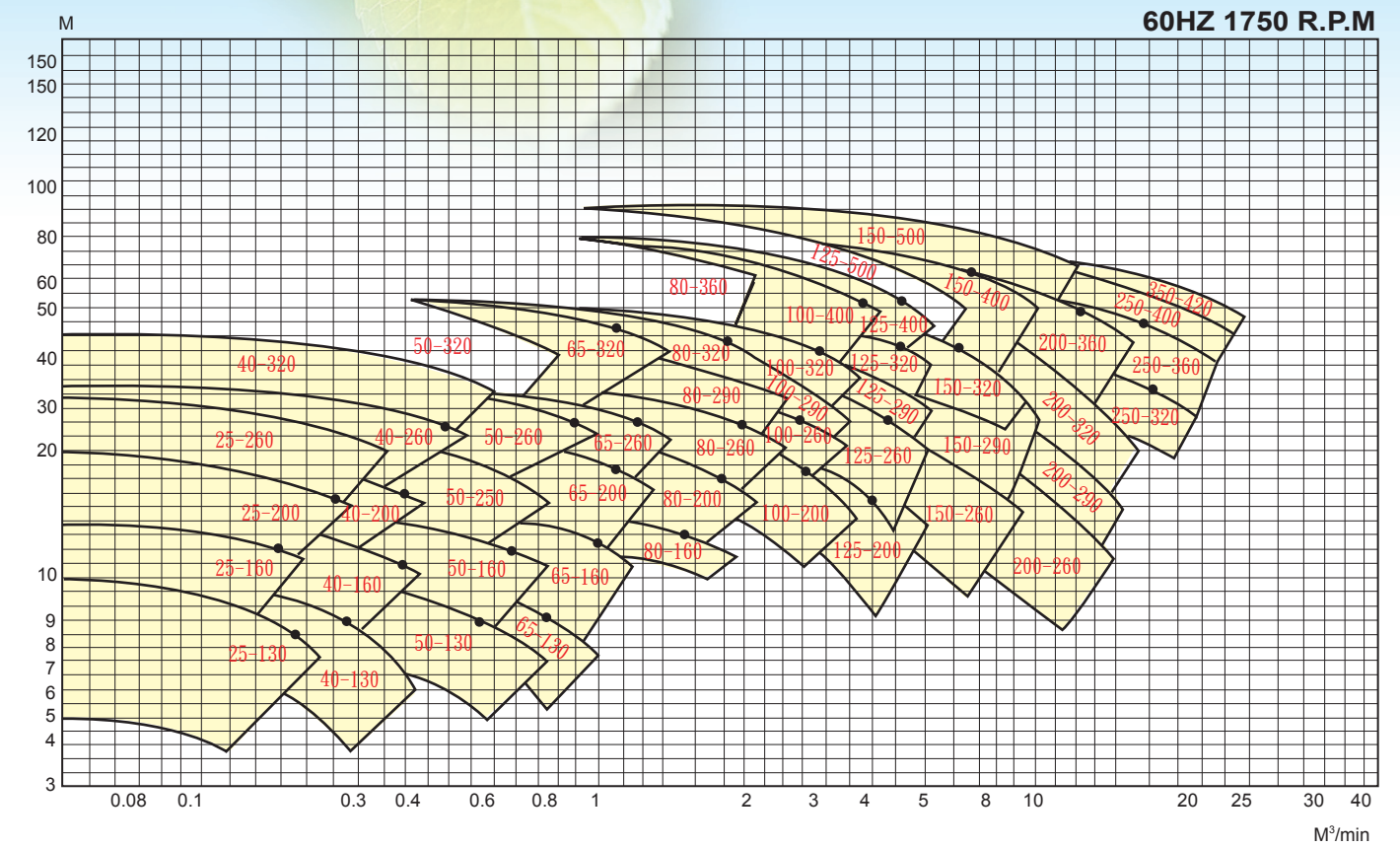

*Our company retains the right of data variation, so please call us for confirmation before purchase